

**490nm~495nm 20mW SM Coaxial Pigtailed Diode Laser Module with 9um Fiber**
**492nm~495nm SM Fiber Coupled LD with 9um Fiber**

WSLP-495-020m-9

Wavespectrum Laser Group

[www.wavespectrum-laser.com](http://www.wavespectrum-laser.com)
[en.wavespectrum-laser.com.cn](http://en.wavespectrum-laser.com.cn)

495nm Pigtailed Diode Laser		20mW/9um	
PARAMETER	SYMBOL	VALUE	UNIT
Reverse Voltage	$V_r$	2.0	V
Operating Temperature	$T_{op}$	-10~+60	°C
Storage Temperature	$T_{stg}$	-40~+85	°C
Lead soldering temperature (10 sec.)	$T_{is}$	260	°C
<b>Features:</b> <ul style="list-style-type: none"> <li>● 495nm Diode Laser</li> <li>● 9um Fiber</li> <li>● Coaxial or B82 Package</li> <li>● High Stability</li> </ul>			
<b>Applications:</b> <ul style="list-style-type: none"> <li>● Medical Laser Treatment</li> <li>● Biotechnology</li> <li>● Others</li> </ul>			
<b>Specifications</b>	<b>WSLP-495-020m-9</b>		
	Min	Type	Max
Center Wavelength@25°C	495nm±10nm		
Spectral Width (FWHM)	----	2.0nm	----
Output Power	----	20mW	----
Fiber Type	SMF-28		
Fiber Core	9um		
Recommend Operating Temperature	25°C		
Fiber Length	----	80cm	100cm
Threshold Current	----	25mA	60mA
Operating Current	----	110mA	130mA
Operating Voltage	----	6.5V	7.5V
Package Style	Coaxial or B82		
Fiber Connector	FC/SC/SMA905		
Photodiode	Without		



**Coaxial Package View: (Part Number: WSLP-495-020m-9)**

**B82 Package View: (Part Number: WSLP-495-020m-9-B)**

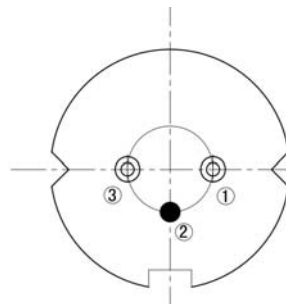
**PIN Bottom View:**

<b>1</b>	<b>LD(+)</b>
<b>2</b>	<b>GND</b>
<b>3</b>	<b>LD(-)</b>



Electrically shorten LD module and store in non-extreme conditions.  
Suggest using the constant current power supply.

