

**820nm 50mW~60mW High Power SM Fiber Coupled LD with Single Mode Fiber | Built-in Photodiode**
**820nm 50mW Single Mode Coaxial Pigtailed Laser Diode with SMF | With PD**
**WSLP-820-050m-4-PD**
**Wavespectrum Laser Group**
**www.wavespectrum-laser.com**

820nm Pigtailed Diode Laser		50mW/SM Fiber		en.wavespectrum-laser.com.cn	
PARAMETER	SYMBOL	VALUE		UNIT	
Reverse Voltage	$V_r$	2.0		V	
Operating Temperature	$T_{op}$	-10~+60		°C	
Storage Temperature	$T_{stg}$	-40~+85		°C	
Lead soldering temperature (10 sec.)	$T_{is}$	260		°C	
<b>Features:</b> <ul style="list-style-type: none"> <li>● 820nm</li> <li>● With SM Fiber</li> <li>● Coaxial or B82 Package</li> <li>● Built-in PD</li> </ul>					
<b>Applications:</b> <ul style="list-style-type: none"> <li>● Medical Laser Treatment</li> <li>● Others</li> </ul>					
<b>Specifications</b>		<b>WSLP-820-050m-4-PD</b>			
		Min	Type	Max	
Center Wavelength@25°C		820nm±10nm			
Recommended Operating Temperature		25°C			
Output Power		----	50mW	----	
Fiber Type		Single Mode Fiber			
Fiber Core		5um			
Monitor Current		----	0.3mA	----	
PD Reverse Voltage		----	----	30V	
Fiber Connector		FC/SC/SMA905			
Fiber Length		>80cm			
Threshold Current (Typ.)		----	30mA	60mA	
Operating Current (Typ.)		----	200mA	220mA	
Operating Voltage		----	2.3V	2.8V	
Package Style		Coaxial or B82			
PD		Built-in			

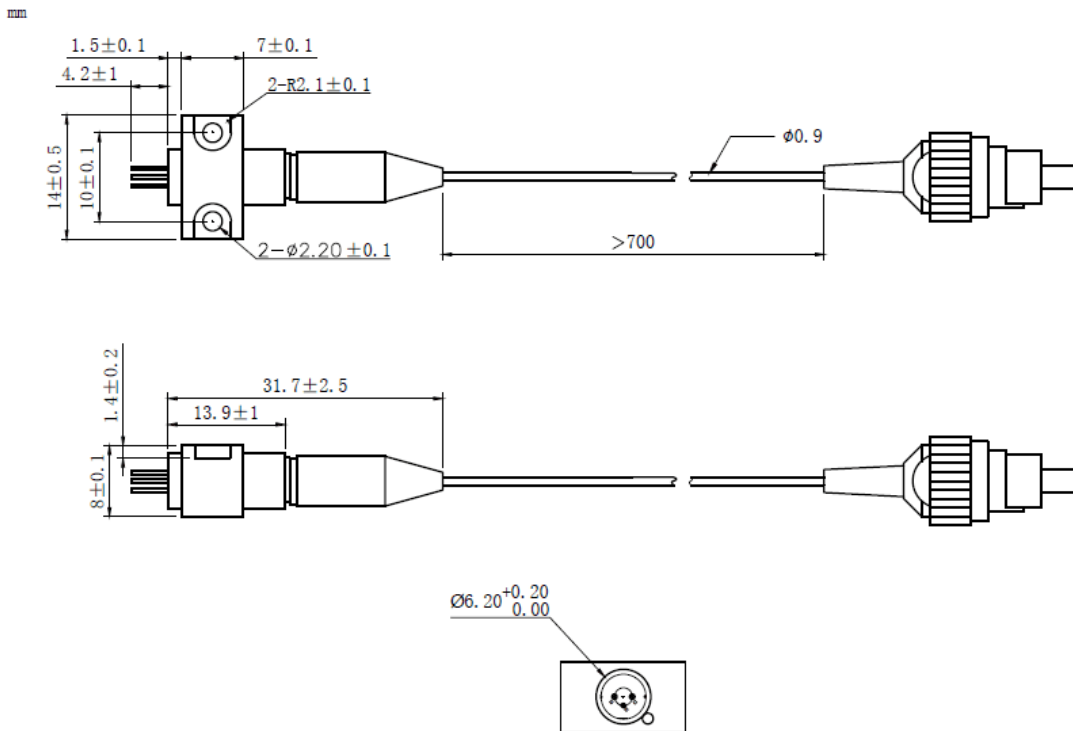
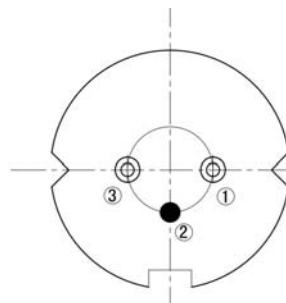

**Coaxial Package View: (Part Number: WSLP-820-050m-4-PD)**

**B82 Package View: (Part Number: WSLP-820-050m-4-B-PD)**

**PIN Bottom View:**

<b>1</b>	<b>LD(-)</b>
<b>2</b>	<b>LD(+)&amp;PD(-)</b>
<b>3</b>	<b>PD(+)</b>



Electrically shorten LD module and store in non-extreme conditions.  
Suggest using the constant current power supply.

