

820nm 30mW~40mW Single Mode Fiber Coupled LD with 5um SMF | Built-in Photodiode
820nm 30mW SM Coaxial Pigtailed Laser Diode with SMF | With PD
WSLP-820-030m-4-PD
Wavespectrum Laser Group
www.wavespectrum-laser.com

820nm Pigtailed Diode Laser		30mW/SM Fiber		en.wavespectrum-laser.com.cn
PARAMETER	SYMBOL	VALUE		UNIT
Reverse Voltage	V_r	2.0		V
Operating Temperature	T_{op}	-10~+60		°C
Storage Temperature	T_{stg}	-40~+85		°C
Lead soldering temperature (10 sec.)	T_{is}	260		°C
Features: <ul style="list-style-type: none"> ● 820nm ● With SM Fiber ● Coaxial or B82 Package ● Built-in PD 				
Applications: <ul style="list-style-type: none"> ● Medical Laser Treatment ● Others 				
Specifications	WSLP-820-030m-4-PD			
	Min	Type	Max	
Center Wavelength@25°C	820nm±10nm			
Recommended Operating Temperature	25°C			
Output Power	----	30mW	----	
Fiber Type	Single Mode Fiber			
Fiber Core	5um			
Monitor Current	----	0.3mA	----	
PD Reverse Voltage	----	----	30V	
Fiber Connector	FC/SC/SMA905			
Fiber Length	>80cm			
Threshold Current (Typ.)	----	30mA	55mA	
Operating Current (Typ.)	----	170mA	190mA	
Operating Voltage	----	1.8V	2.5V	
Package Style	Coaxial or B82			
PD	Built-in			

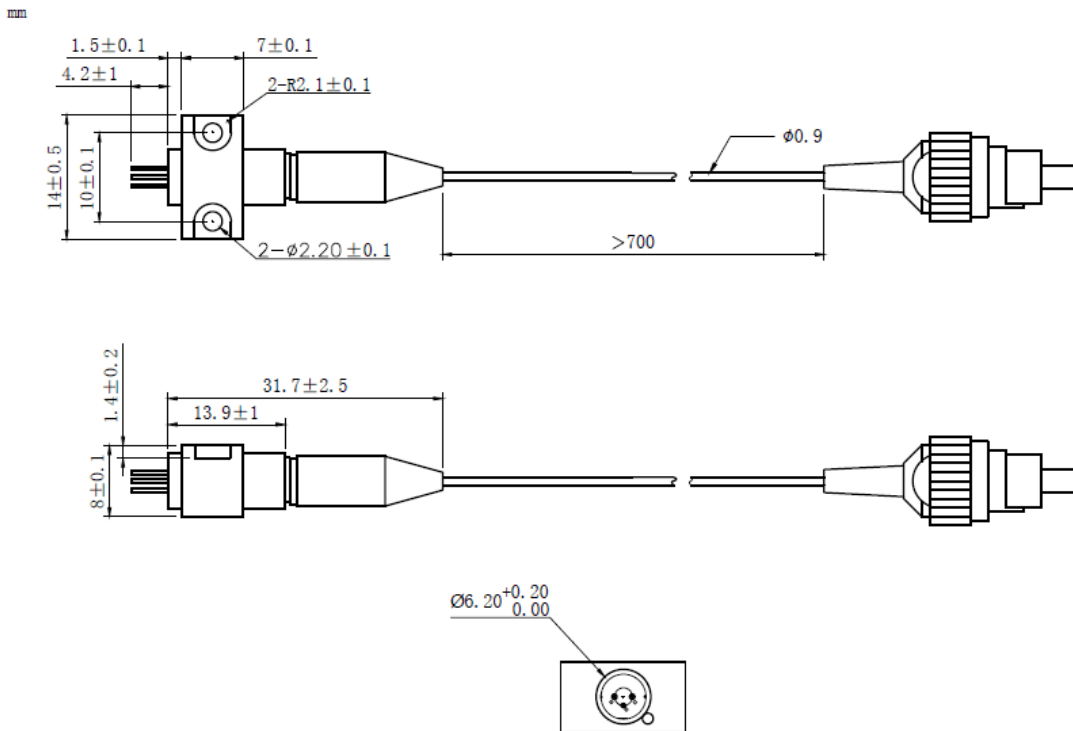
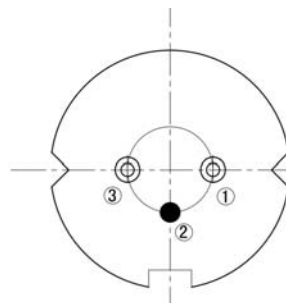

Coaxial Package View: (Part Number: WSLP-820-030m-4-PD)

B82 Package View: (Part Number: WSLP-820-030m-4-B-PD)

PIN Bottom View:

1	LD(-)
2	LD(+)&PD(-)
3	PD(+)



Electrically shorten LD module and store in non-extreme conditions.
Suggest using the constant current power supply.

