

**658nm~660nm 80mW SM Coaxial Pigtailed Laser Diode with Polarization Maintaining Fiber (PM Fiber)**
**660nm 80mW High Power PM Fiber Coupled Diode Laser Module| Polarization Maintaining Fiber (PMF)**
**WSLP-660-080m-PM**
**Wavespectrum Laser Group**
**www.wavespectrum-laser.com**

660nm Pigtailed Diode Laser		80mW/PM Fiber		en.wavespectrum-laser.com.cn	
PARAMETER	SYMBOL	VALUE		UNIT	
Reverse Voltage	$V_r$	2.0		V	
Operating Temperature	$T_{op}$	-10~+60		°C	
Storage Temperature	$T_{stg}$	-40~+85		°C	
Lead soldering temperature (10 sec.)	$T_{is}$	260		°C	
<b>Features:</b> <ul style="list-style-type: none"> <li>● 660nm</li> <li>● 4um PM Fiber</li> <li>● High Stability</li> <li>● High Polarization Extinction Ratio</li> </ul>					
<b>Applications:</b> <ul style="list-style-type: none"> <li>● Medical Laser Treatment</li> <li>● Others</li> </ul>					
<b>Specifications</b>		<b>WSLP-660-080m-PM</b>			
		Min	Type	Max	
Center Wavelength@25°C		660nm±10nm			
Recommended Operating Temperature		25°C			
Output Power		----	80mW	----	
Fiber Type		Polarization Maintaining Fiber			
Fiber Core		4um			
Polarization Extinction Ratio		13dB	15dB		
Fiber Length		>80cm			
Threshold Current		----	55mA	85mA	
Operating Current		----	220mA	240mA	
Operating Voltage		----	2.8V	3.5V	
Fiber Connector		FC/APC			
Package Style		Coaxial or B82			
High Polarization Extinction Ratio (PER) Version Laser Module is also available, please contact us.					

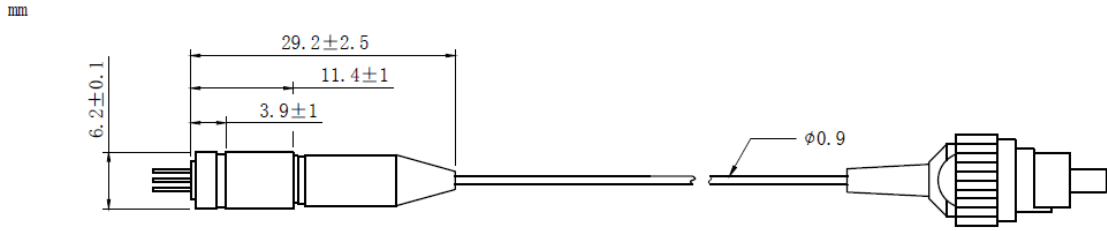
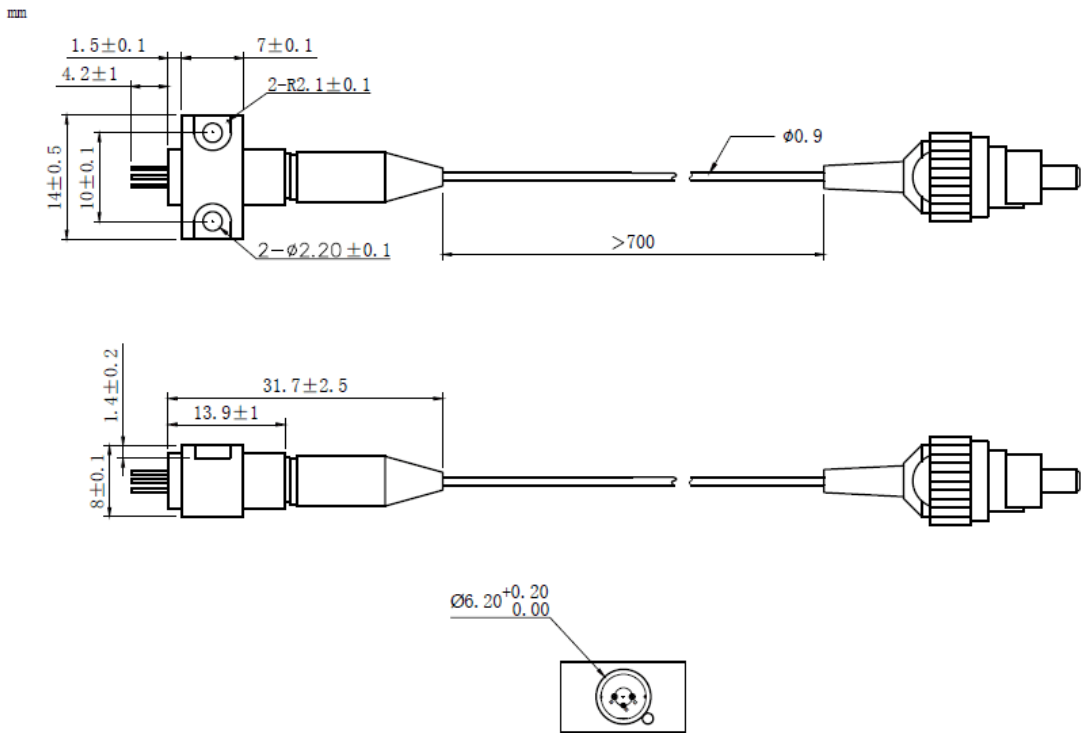
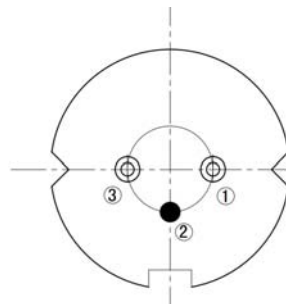

**Coaxial Package View: (Part Number: WSLP-660-080m-PM)**

**B82 Package View: (Part Number: WSLP-660-080m-PM-B)**

**PIN Bottom View:**

<b>1</b>	<b>LD(+)</b>
<b>2</b>	<b>LD(-)</b>
<b>3</b>	<b>NC</b>



Electrically shorten LD module and store in non-extreme conditions.  
Suggest using the constant current power supply.

