

**638nm~640nm 50mW~60mW Single Mode Fiber Coupled Diode Laser with Photodiode (PD)**  
**640nm 50mW Coaxial Pigtailed Laser Diode with 4um Single Mode Fiber (SM Fiber)**  
 WSLP-640-050m-4-PD                      Wavespectrum Laser Group                      www.wavespectrum-laser.com

**640nm Pigtailed Diode Laser    50mW/SMF**                      [en.wavespectrum-laser.com.cn](http://en.wavespectrum-laser.com.cn)

PARAMETER	SYMBOL	VALUE	UNIT
Reverse Voltage	$V_r$	2.0	V
Operating Temperature	$T_{op}$	-10~+60	°C
Storage Temperature	$T_{stg}$	-40~+85	°C
Lead soldering temperature (10 sec.)	$T_{is}$	260	°C

<b>Features:</b> <ul style="list-style-type: none"> <li><span style="color: #0056b3;">●</span> 640nm</li> <li><span style="color: #0056b3;">●</span> 4um SM Fiber</li> <li><span style="color: #0056b3;">●</span> Coaxial or B82 Package</li> <li><span style="color: #0056b3;">●</span> Built-in PD</li> </ul>	
<b>Applications:</b> <ul style="list-style-type: none"> <li><span style="color: #0056b3;">●</span> Medical Laser Treatment</li> <li><span style="color: #0056b3;">●</span> Aiming Beam</li> <li><span style="color: #0056b3;">●</span> Others</li> </ul>	

Specifications	WSLP-640-050m-4-PD		
	Min	Type	Max
Center Wavelength@25°C	640nm±10nm		
Recommended work Temperature	25°C		
Output Power	----	50mW	----
Fiber Type	Single Mode Fiber		
Fiber Core	4um		
Monitor Current	----	0.3mA	----
PD Reverse Voltage	----	----	30V
Fiber Connector	FC/SC/SMA905		
Fiber Length	>80cm		
Threshold Current	----	60mA	85mA
Operating Current	----	220mA	240mA
Operating Voltage	----	2.7V	3.3V
Package Style	Coaxial or B82		
PD	Built-in		

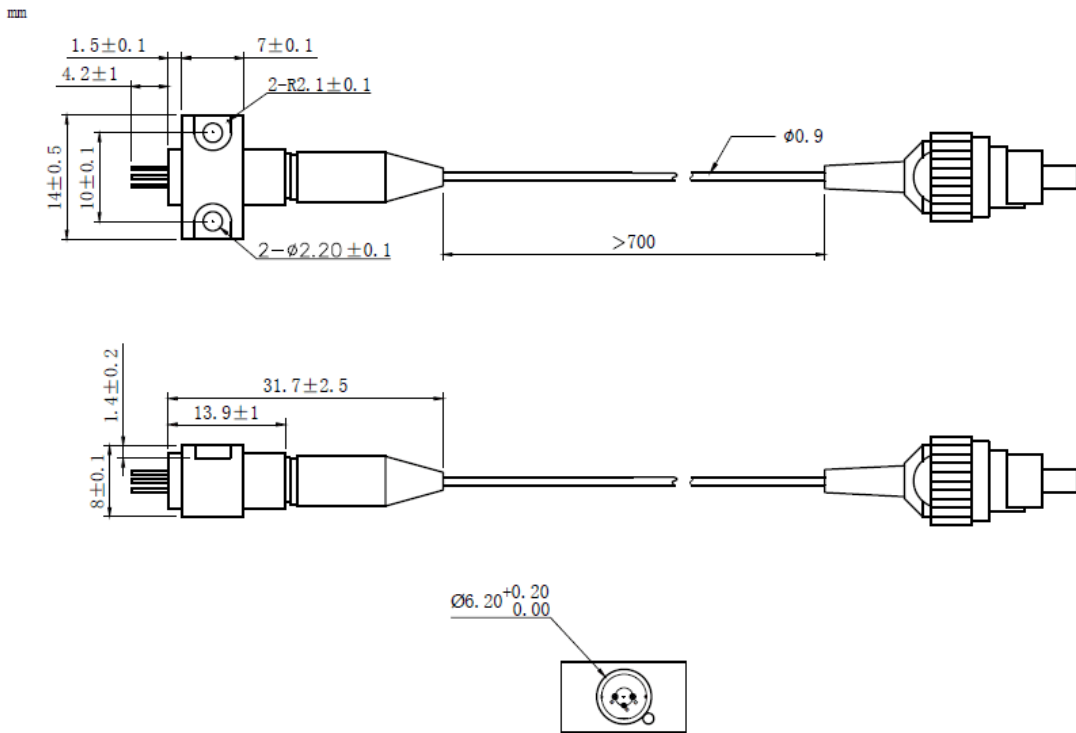
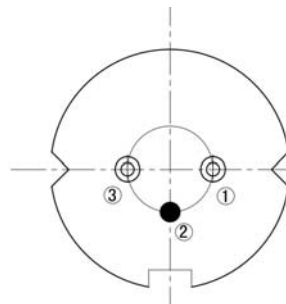

**Coaxial Package View: (Part Number: WSLP-640-050m-4-PD)**

**B82 Package View: (Part Number: WSLP-640-050m-4-B-PD)**

**PIN Bottom View:**

1	LD(-)
2	LD(+) & PD(-)
3	PD(+)



Electrically shorten LD module and store in non-extreme conditions.  
Suggest using the constant current power supply.

