

640nm~642nm 5mW Single Mode Fiber Coupled Diode Laser with Photodiode (PD)
640nm 5mW Coaxial Pigtailed Laser Diode with 4um Single Mode Fiber (SM Fiber)

WSLP-640-005m-4-PD

Wavespectrum Laser Group

www.wavespectrum-laser.com
640nm Pigtailed Diode Laser 5mW/SMF
en.wavespectrum-laser.com.cn

PARAMETER	SYMBOL	VALUE	UNIT
Reverse Voltage	V_r	2.0	V
Operating Temperature	T_{op}	-10~+50	°C
Storage Temperature	T_{stg}	-40~+85	°C
Lead soldering temperature (10 sec.)	T_{is}	260	°C
Features: <ul style="list-style-type: none"> ● 640nm ● 4um SM Fiber ● Coaxial or B82 Package ● Built-in PD 			
Applications: <ul style="list-style-type: none"> ● Medical Laser Treatment ● Aiming Beam ● Others 			
Specifications	WSLP-640-005m-4-PD		
	Min	Type	Max
Center Wavelength@25°C	640nm±10nm		
Recommended work Temperature	25°C		
Output Power	----	5mW	----
Fiber Type	Single Mode Fiber		
Fiber Core	4um		
Monitor Current	----	0.2mA	----
PD Reverse Voltage	----	----	30V
Fiber Connector	FC/SC/SMA905		
Fiber Length	>80cm		
Threshold Current	----	45mA	60mA
Operating Current	----	65mA	75mA
Operating Voltage	----	2.4V	2.8V
Package Style	Coaxial or B82		
PD	Built-in		

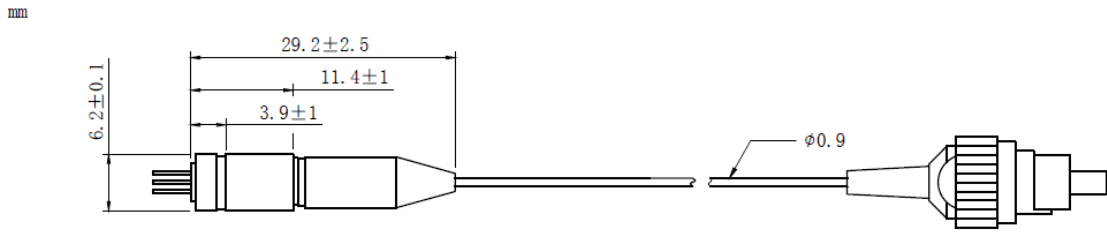
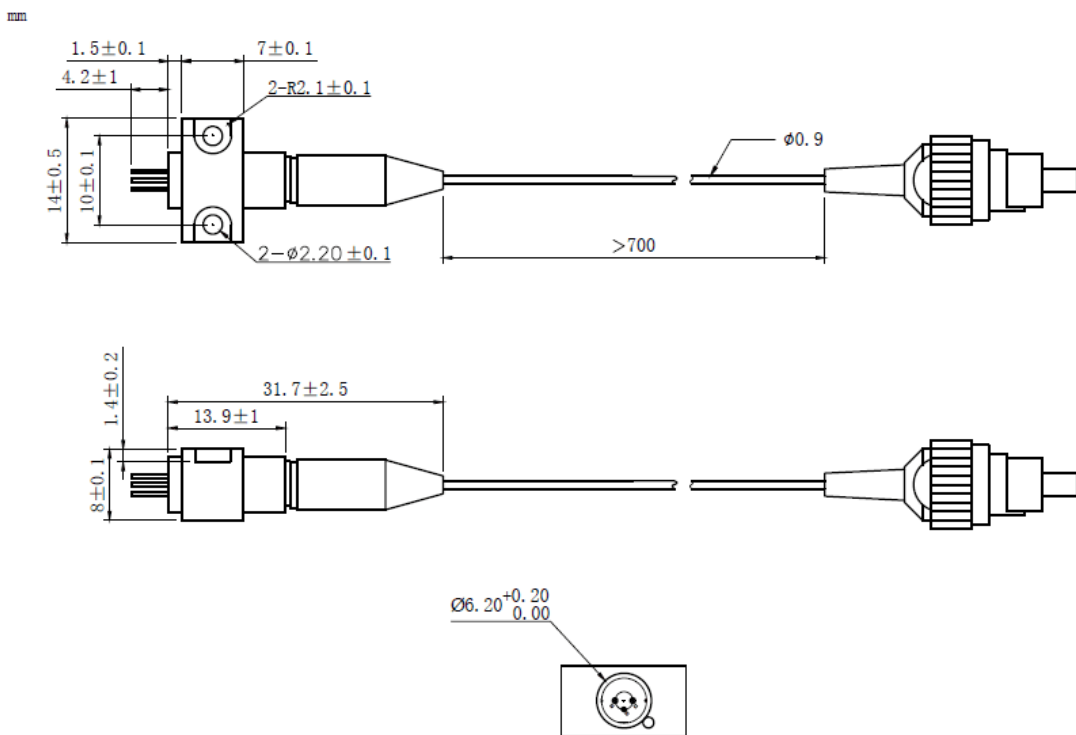
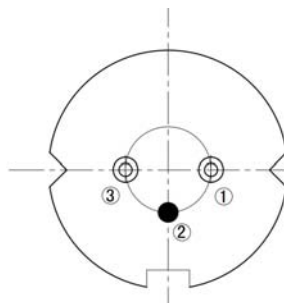

Coaxial Package View: (Part Number: WSLP-640-005m-4-PD)

B82 Package View: (Part Number: WSLP-640-005m-4-B-PD)

PIN Bottom View:

1	LD(-)
2	LD(+)&PD(-)
3	PD(+)



Electrically shorten LD module and store in non-extreme conditions.
Suggest using the constant current power supply.

