

510nm 10mW SM Coaxial Diode Laser with Polarization Maintaining Fiber
505nm~510nm PM Fiber Coupled Laser Diode with SMF | Green LD Module
 WSLP-510-010m-PM Wavespectrum Laser Group www.wavespectrum-laser.com

www.wavespectrum-laser.com

en.wavespectrum-laser.com.cn

510nm Pigtailed Diode Laser		10mW/PMF	
PARAMETER	SYMBOL	VALUE	UNIT
Reverse Voltage	V_r	2.0	V
Operating Temperature	T_{op}	-10 ~ +60	°C
Storage Temperature	T_{stg}	-40 ~ +85	°C
Lead soldering temperature (10 sec.)	T_{is}	260	°C
Features: <ul style="list-style-type: none"> ● 510nm Green Diode Laser ● PM Fiber ● High Reliability ● High Polarization Extinction Ratio 			
Applications: <ul style="list-style-type: none"> ● Biological Instruments ● Analytical Equipment ● Others 			
Specifications	WSLP-510-010m-PM		
	Min	Type	Max
Center Wavelength@25°C	510nm±10nm		
Spectral Width (FWHM)	----	2.0nm	----
Output Power	----	10mW	----
Fiber Type	Polarization Maintaining Fiber		
Fiber Core	3um		
Polarization Extinction Ratio	13dB	15dB	----
Recommend Operating Temperature	25°C		
Fiber Connector	FC/APC		
Fiber Length	>80cm		
Threshold Current	----	50mA	90mA
Operating Current	----	180mA	200mA
Operating Voltage	----	7.5V	8.0V
Package Style	Coaxial or B82		
High Polarization Extinction Ratio (PER) Version Laser Module is also available, please contact us.			

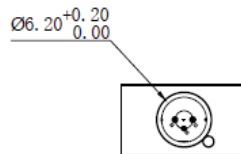
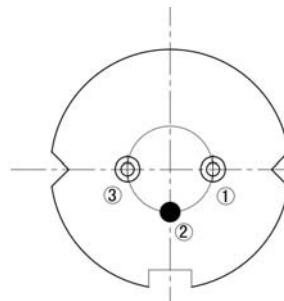

Coaxial Package View: (Part Number: WSLP-510-010m-PM)

B82 Package View: (Part Number: WSLP-510-010m-PM-B)

PIN Bottom View:

1	LD(+)
2	GND
3	LD(-)



Electrically shorten LD module and store in non-extreme conditions.
Suggest using the constant current power supply.

