

490nm~495nm 20mW Single Mode Coaxial Package Fiber Coupled Laser Diode Module
492nm~495nm SM Pigtailed LD with 3um Single Mode Fiber (SM Fiber) | Blue LDM

WSLP-495-020m-4

Wavespectrum Laser Group

www.wavespectrum-laser.com

495nm Pigtailed Diode Laser		20mW/SMF		en.wavespectrum-laser.com.cn	
PARAMETER	SYMBOL	VALUE	UNIT		
Reverse Voltage	V_r	2.0	V		
Operating Temperature	T_{op}	-10~+60	°C		
Storage Temperature	T_{stg}	-40~+85	°C		
Lead soldering temperature (10 sec.)	T_{is}	260	°C		
Features: <ul style="list-style-type: none"> ● 495nm Diode Laser ● 3um SM Fiber ● Coaxial or B82 Package ● High Stability 					
Applications: <ul style="list-style-type: none"> ● Medical Laser Treatment ● Biotechnology ● Others 					
Specifications	WSLP-495-020m-4				
	Min	Type	Max		
Center Wavelength@25°C	495nm±10nm				
Spectral Width (FWHM)	----	2.0nm	----		
Output Power	----	20mW	----		
Fiber Type	Single Mode Fiber				
Fiber Core	3um				
Recommend Operating Temperature	25°C				
Fiber Length	>80cm				
Threshold Current	----	20mA	60mA		
Operating Current	----	140mA	160mA		
Operating Voltage	----	6.5V	8.0V		
Package Style	Coaxial or B82				
Fiber Connector	FC/SC/SMA905				
Photodiode	Without				

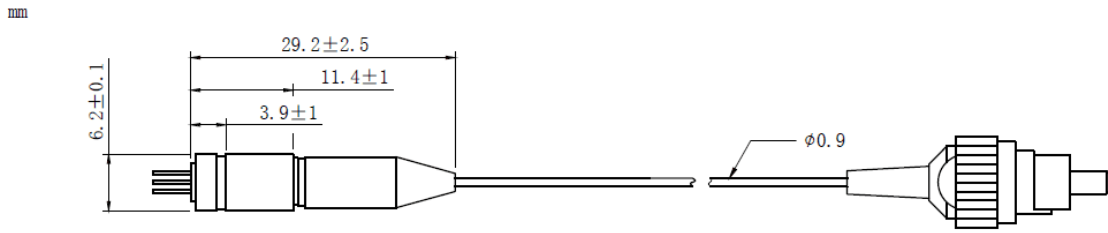
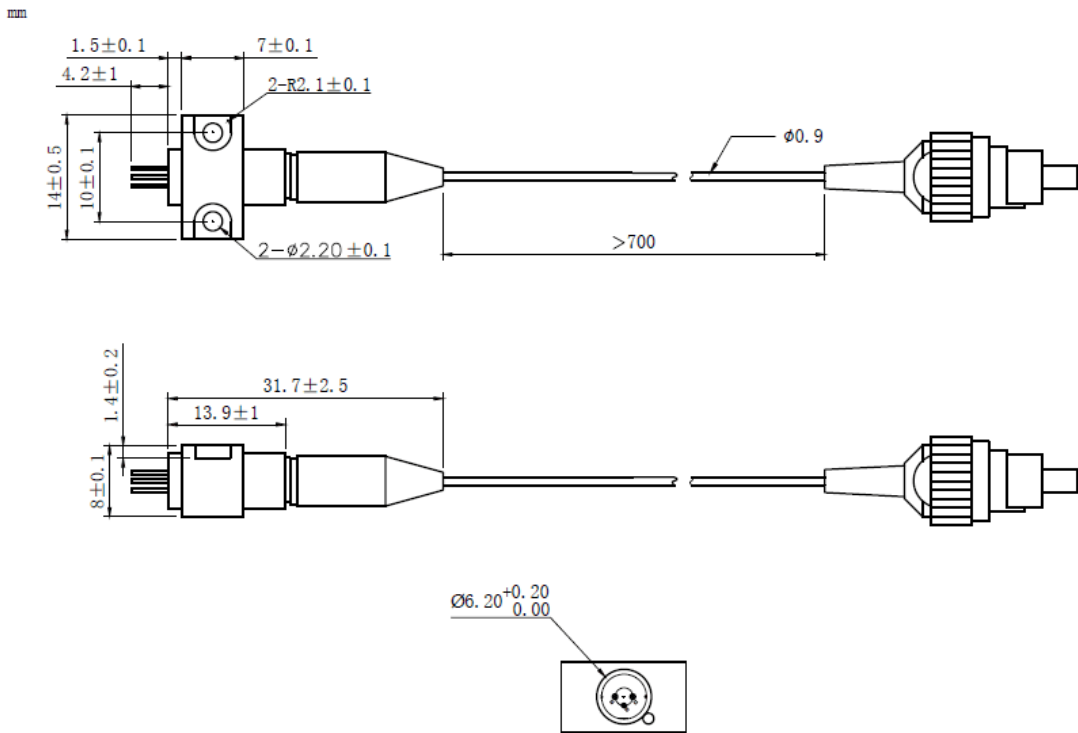
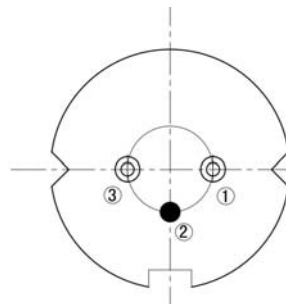

Coaxial Package View: (Part Number: WSLP-495-020m-4)

B82 Package View: (Part Number: WSLP-495-020m-4-B)

PIN Bottom View:

1	LD(+)
2	GND
3	LD(-)



Electrically shorten LD module and store in non-extreme conditions.
Suggest using the constant current power supply.

