

## OEM Fiber Coupled Diode Laser System

### PRODUCT FEATURE

405nm~1920nm  
 OEM Laser System  
 Integrated Package Size  
 SMF/PMF/MMF Optional  
 1mW~12W Output Power  
 Built-in TE Cooling & Driver  
 5V/12V /24V DC Input  
 TTL/Analog Modulation  
 Long Lifetime  
 High Stability  
 Customized Wavelength/Power/Fiber Type



### PRODUCT OVERVIEW

OEM Fiber Coupled Diode Laser System is the most competitive product of WAVESPECTRUM.

We offer 405nm~1920nm Fiber Coupled Laser Source with Single Mode Fiber (SMF), Multimode Fiber (MMF) and Polarization Maintaining Fiber (PMF) . The Output Power is from 1mW to 12W.

The OEM Fiber Coupled Diode Laser System contains the Fiber Coupled Laser Module, LD Driver and Temperature Control System. It is with integrated package design and small size. Just need Input 5V/12V/24V DC can work the Laser Source, it is easy to use. To ensure the long-time reliability and power stability, each Laser System will undergo rigorous testing and aging in factory.



Wavelength	Part Number	Output Power Range	Fiber Type	Fiber Core	Supply Voltage	Connector	TEC	Analog	TTL
405nm	WSLS-405-015m-4-DC	0 ~ 15mW	SM	3um	7.5VDC	FC/SMA	√	○	○
	WSLS-405-030m-4-DC	0 ~ 30mW	SM	3um	7.5VDC	FC/SMA	√	○	○
	WSLS-405-050m-4-DC	0 ~ 50mW	SM	3um	7.5VDC	FC/SMA	√	○	○
	WSLS-405-080m-4-DC	0 ~ 80mW	SM	3um	7.5VDC	FC/SMA	√	○	○
	WSLS-405-100m-4-DC	0 ~ 100mW	SM	3um	7.5VDC	FC/SMA	√	○	○
	WSLS-405-015m-PM-DC	0 ~ 15mW	PM	3um	7.5VDC	FC	√	○	○
	WSLS-405-030m-PM-DC	0 ~ 30mW	PM	3um	7.5VDC	FC	√	○	○
	WSLS-405-050m-PM-DC	0 ~ 50mW	PM	3um	7.5VDC	FC	√	○	○
	WSLS-405-080m-PM-DC	0 ~ 80mW	PM	3um	7.5VDC	FC	√	○	○
	WSLS-405-100m-PM-DC	0 ~ 100mW	PM	3um	7.5VDC	FC	√	○	○
	WSLS-405-200m-M-DC	0 ~ 200mW	MM	105um	7.5VDC	FC/SMA	√	○	○
	WSLS-405-300m-M-DC	0 ~ 300mW	MM	105um	7.5VDC	FC/SMA	√	○	○
	WSLS-405-1200m-M-DC	0 ~ 1.2W	MM	<400um	24VDC	FC/SMA	√	○	○
	WSLS-405-002-M-DC	0 ~ 2W	MM	<400um	24VDC	FC/SMA	√	○	○
	WSLS-405-005-M-DC	0 ~ 5W	MM	<650um	24VDC	FC/SMA	NO	○	○
WSLS-405-010-M-DC	0 ~ 10W	MM	<1000um	24VDC	FC/SMA	NO	○	○	
445nm	WSLS-445-020m-4-DC	0 ~ 20mW	SM	3um	7.5VDC	FC/SMA	√	○	○
	WSLS-445-030m-4-DC	0 ~ 30mW	SM	3um	7.5VDC	FC/SMA	√	○	○
	WSLS-445-040m-4-DC	0 ~ 40mW	SM	3um	7.5VDC	FC/SMA	√	○	○
	WSLS-445-020m-PM-DC	0 ~ 20mW	PM	3um	7.5VDC	FC	√	○	○
	WSLS-445-030m-PM-DC	0 ~ 30mW	PM	3um	7.5VDC	FC	√	○	○
	WSLS-445-050m-M-DC	0 ~ 50mW	MM	50um	7.5VDC	FC/SMA	√	○	○
	WSLS-445-001-M-DC	0 ~ 1W	MM	105um	7.5VDC	FC/SMA	√	○	○
WSLS-445-3500m-M-DC	0 ~ 3.5W	MM	200um	7.5VDC	FC/SMA	√	○	○	
465nm	WSLS-465-002-M-DC	0 ~ 2W	MM	105um	7.5VDC	FC/SMA	√	○	○
488nm	WSLS-488-015m-4-DC	0 ~ 15mW	SM	3um	7.5VDC	FC/SMA	√	○	○
	WSLS-488-020m-4-DC	0 ~ 20mW	SM	3um	7.5VDC	FC/SMA	√	○	○
	WSLS-488-015m-PM-DC	0 ~ 15mW	PM	3um	7.5VDC	FC	√	○	○
	WSLS-488-020m-PM-DC	0 ~ 20mW	PM	3um	7.5VDC	FC	√	○	○
	WSLS-488-040m-M-DC	0 ~ 40mW	MM	105um	7.5VDC	FC/SMA	√	○	○
505nm	WSLS-505-010m-4-DC	0 ~ 10mW	SM	3um	7.5VDC	FC/SMA	√	○	○
	WSLS-505-020m-4-DC	0 ~ 20mW	SM	3um	7.5VDC	FC/SMA	√	○	○
	WSLS-505-010m-PM-DC	0 ~ 10mW	PM	3um	7.5VDC	FC	√	○	○
	WSLS-505-020m-PM-DC	0 ~ 20mW	PM	3um	7.5VDC	FC	√	○	○
	WSLS-505-030m-M-DC	0 ~ 30mW	MM	105um	7.5VDC	FC/SMA	√	○	○
	WSLS-505-050m-M-DC	0 ~ 50mW	MM	105um	7.5VDC	FC/SMA	√	○	○
520nm	WSLS-520-010m-4-DC	0 ~ 10mW	SM	3um	7.5VDC	FC/SMA	√	○	○
	WSLS-520-020m-4-DC	0 ~ 20mW	SM	3um	7.5VDC	FC/SMA	√	○	○
	WSLS-520-025m-4-DC	0 ~ 25mW	SM	3um	7.5VDC	FC/SMA	√	○	○
	WSLS-520-010m-PM-DC	0 ~ 10mW	PM	3um	7.5VDC	FC	√	○	○

Note: √:Yes, ○:Optional, x:No.

Wavelength	Part Number	Output Power Range	Fiber Type	Fiber Core	Supply Voltage	Connector	TEC	Analog	TTL
520nm	WSLS-520-020m-PM-DC	0 ~ 20mW	PM	3um	7.5VDC	FC	√	○	○
	WSLS-520-025m-PM-DC	0 ~ 25mW	PM	3um	7.5VDC	FC	√	○	○
	WSLS-520-050m-M-DC	0 ~ 50mW	MM	105um	7.5VDC	FC/SMA	√	○	○
	WSLS-520-700m-M-DC	0 ~ 700mW	MM	105um	7.5VDC	FC/SMA	√	○	○
525nm	WSLS-525-700m-M-DC	0 ~ 700mW	MM	105um	7.5VDC	FC/SMA	√	○	○
635nm	WSLS-635-030m-4-DC	0 ~ 30mW	SM	4um	5VDC	FC/SMA	√	○	○
	WSLS-635-050m-4-DC	0 ~ 50mW	SM	4um	5VDC	FC/SMA	√	○	○
	WSLS-635-070m-4-DC	0 ~ 70mW	SM	4um	5VDC	FC/SMA	√	○	○
	WSLS-635-030m-PM-DC	0 ~ 30mW	PM	4um	5VDC	FC	√	○	○
	WSLS-635-050m-PM-DC	0 ~ 50mW	PM	4um	5VDC	FC	√	○	○
	WSLS-635-070m-PM-DC	0 ~ 70mW	PM	4um	5VDC	FC	√	○	○
	WSLS-635-100m-M-DC	0 ~ 100mW	MM	105um	5VDC	FC/SMA	√	○	○
	WSLS-635-300m-M-DC	0 ~ 300mW	MM	105um	5VDC	FC/SMA	√	○	○
	WSLS-635-001-M-DC	0 ~ 1W	MM	105um	5VDC	FC/SMA	√	○	○
	WSLS-635-1800m-M-DC	0 ~ 1.8W	MM	200um	5VDC	FC/SMA	√	○	○
658nm	WSLS-650-050m-4-DC	0 ~ 50mW	SM	4um	5VDC	FC/SMA	√	○	○
	WSLS-650-080m-4-DC	0 ~ 80mW	SM	4um	5VDC	FC/SMA	√	○	○
	WSLS-650-100m-4-DC	0 ~ 100mW	SM	4um	5VDC	FC/SMA	√	○	○
	WSLS-650-030m-PM-DC	0 ~ 30mW	PM	4um	5VDC	FC	√	○	○
	WSLS-650-050m-PM-DC	0 ~ 50mW	PM	4um	5VDC	FC	√	○	○
	WSLS-650-080m-PM-DC	0 ~ 80mW	PM	4um	5VDC	FC	√	○	○
	WSLS-650-100m-M-DC	0 ~ 100mW	MM	105um	5VDC	FC/SMA	√	○	○
	WSLS-650-700m-M-DC	0 ~ 700mW	MM	105um	5VDC	FC/SMA	√	○	○
670nm	WSLS-670-003m-4-DC	0 ~ 3mW	SM	3um	5VDC	FC/SMA	√	○	○
	WSLS-670-005m-4-DC	0 ~ 5mW	SM	3um	5VDC	FC/SMA	√	○	○
	WSLS-670-003m-PM-DC	0 ~ 3mW	PM	3um	5VDC	FC	√	○	○
	WSLS-670-005m-PM-DC	0 ~ 5mW	PM	3um	5VDC	FC	√	○	○
680nm	WSLS-680-700m-M-DC	0 ~ 700mW	MM	105um	5VDC	FC/SMA	√	○	○
685nm	WSLS-685-010m-4-DC	0 ~ 10mW	SM	4um	5VDC	FC/SMA	√	○	○
	WSLS-685-015m-4-DC	0 ~ 15mW	SM	4um	5VDC	FC/SMA	√	○	○
	WSLS-685-010m-PM-DC	0 ~ 10mW	PM	4um	5VDC	FC	√	○	○
	WSLS-685-015m-PM-DC	0 ~ 15mW	PM	4um	5VDC	FC	√	○	○
	WSLS-685-030m-M-DC	0 ~ 30mW	MM	105um	5VDC	FC/SMA	√	○	○
760nm	WSLS-760-1500m-M-DC	0 ~ 1.5W	MM	105um	5VDC	FC/SMA	√	○	○
785nm	WSLS-785-030m-4-DC	0 ~ 30mW	SM	5um	5VDC	FC/SMA	√	○	○
	WSLS-785-040m-4-DC	0 ~ 40mW	SM	5um	5VDC	FC/SMA	√	○	○
	WSLS-785-030m-PM-DC	0 ~ 30mW	PM	5um	5VDC	FC	√	○	○
	WSLS-785-040m-PM-DC	0 ~ 40mW	PM	5um	5VDC	FC	√	○	○
	WSLS-785-003-M-DC	0 ~ 3W	MM	105um	5VDC	FC/SMA	√	○	○
808nm	WSLS-808-030m-4-DC	0 ~ 30mW	SM	5um	5VDC	FC/SMA	√	○	○

Note: √:Yes, ○:Optional, ×:No.

Wavelength	Part Number	Output Power Range	Fiber Type	Fiber Core	Supply Voltage	Connector	TEC	Analog	TTL
808nm	WSLS-808-050m-4-DC	0 ~ 50mW	SM	5um	5VDC	FC/SMA	√	○	○
	WSLS-808-020m-PM-DC	0 ~ 20mW	PM	5um	5VDC	FC	√	○	○
	WSLS-808-040m-PM-DC	0 ~ 40mW	PM	5um	5VDC	FC	√	○	○
	WSLS-808-150m-M-DC	0 ~ 150mW	MM	105um	5VDC	FC/SMA	√	○	○
	WSLS-808-002-M-DC	0 ~ 2W	MM	105um	5VDC	FC/SMA	√	○	○
	WSLS-808-003-M-DC	0 ~ 3W	MM	105um	5VDC	FC/SMA	√	○	○
	WSLS-808-004-M-DC	0 ~ 4W	MM	105um	12VDC	FC/SMA	√	○	○
	WSLS-808-005-M-DC	0 ~ 5W	MM	105um	12VDC	FC/SMA	√	○	○
	WSLS-808-007-M-DC	0 ~ 7W	MM	105um	12VDC	FC/SMA	√	○	○
830nm	WSLS-830-030m-4-DC	0 ~ 30mW	SM	5um	5VDC	FC/SMA	√	○	○
	WSLS-830-050m-4-DC	0 ~ 50mW	SM	5um	5VDC	FC/SMA	√	○	○
	WSLS-830-080m-4-DC	0 ~ 80mW	SM	5um	5VDC	FC/SMA	√	○	○
	WSLS-830-100m-4-DC	0 ~ 100mW	SM	5um	5VDC	FC/SMA	√	○	○
	WSLS-830-030m-PM-DC	0 ~ 30mW	PM	5um	5VDC	FC	√	○	○
	WSLS-830-050m-PM-DC	0 ~ 50mW	PM	5um	5VDC	FC	√	○	○
	WSLS-830-080m-PM-DC	0 ~ 80mW	PM	5um	5VDC	FC	√	○	○
	WSLS-830-100m-PM-DC	0 ~ 100mW	PM	5um	5VDC	FC	√	○	○
	WSLS-830-120m-M-DC	0 ~ 120mW	MM	105um	5VDC	FC/SMA	√	○	○
	WSLS-830-001-M-DC	0 ~ 1W	MM	50um	5VDC	FC/SMA	√	○	○
	WSLS-830-002-M-DC	0 ~ 2W	MM	105um	5VDC	FC/SMA	√	○	○
	WSLS-830-003-M-DC	0 ~ 3W	MM	105um	5VDC	FC/SMA	√	○	○
850nm	WSLS-850-030m-4-DC	0 ~ 30mW	SM	5um	5VDC	FC/SMA	√	○	○
	WSLS-850-050m-4-DC	0 ~ 50mW	SM	5um	5VDC	FC/SMA	√	○	○
	WSLS-850-070m-4-DC	0 ~ 70mW	SM	5um	5VDC	FC/SMA	√	○	○
	WSLS-850-030m-PM-DC	0 ~ 30mW	PM	5um	5VDC	FC	√	○	○
	WSLS-850-050m-PM-DC	0 ~ 50mW	PM	5um	5VDC	FC	√	○	○
	WSLS-850-070m-PM-DC	0 ~ 70mW	PM	5um	5VDC	FC	√	○	○
	WSLS-850-120m-M-DC	0 ~ 120mW	MM	105um	5VDC	FC/SMA	√	○	○
860nm	WSLS-860-002-M-DC	0 ~ 2W	MM	105um	5VDC	FC/SMA	√	○	○
880nm	WSLS-880-002m-4-DC	0 ~ 2mW	SM	5um	5VDC	FC/SMA	√	○	○
	WSLS-880-002m-PM-DC	0 ~ 2mW	PM	5um	5VDC	FC	√	○	○
	WSLS-880-002-M-DC	0 ~ 2W	MM	105um	5VDC	FC/SMA	√	○	○
	WSLS-880-003-M-DC	0 ~ 3W	MM	105um	5VDC	FC/SMA	√	○	○
905nm	WSLS-905-020m-4-DC	0 ~ 20mW	SM	5um	5VDC	FC/SMA	√	○	○
	WSLS-905-030m-4-DC	0 ~ 30mW	SM	5um	5VDC	FC/SMA	√	○	○
	WSLS-905-020m-PM-DC	0 ~ 20mW	PM	5um	5VDC	FC	√	○	○
	WSLS-905-030m-PM-DC	0 ~ 30mW	PM	5um	5VDC	FC	√	○	○
	WSLS-905-050m-M-DC	0 ~ 50mW	MM	105um	5VDC	FC/SMA	√	○	○
915nm	WSLS-915-002-M-DC	0 ~ 2W	MM	105um	5VDC	FC/SMA	√	○	○
	WSLS-915-010-M-DC	0 ~ 10W	MM	105um	12VDC	FC/SMA	√	○	○

Note: √:Yes, ○:Optional, ×:No.

Wavelength	Part Number	Output Power Range	Fiber Type	Fiber Core	Supply Voltage	Connector	TEC	Analog	TTL
915nm	WSLS-915-012-M-DC	0 ~ 12W	MM	105um	12VDC	FC/SMA	√	○	○
940nm	WSLS-940-030m-4-DC	0 ~ 30mW	SM	5um	5VDC	FC/SMA	√	○	○
	WSLS-940-050m-4-DC	0 ~ 50mW	SM	5um	5VDC	FC/SMA	√	○	○
	WSLS-940-070m-4-DC	0 ~ 70mW	SM	5um	5VDC	FC/SMA	√	○	○
	WSLS-940-030m-PM-DC	0 ~ 30mW	PM	5um	5VDC	FC	√	○	○
	WSLS-940-050m-PM-DC	0 ~ 50mW	PM	5um	5VDC	FC	√	○	○
	WSLS-940-070m-PM-DC	0 ~ 70mW	PM	5um	5VDC	FC	√	○	○
	WSLS-940-100m-M-DC	0 ~ 100mW	MM	105um	5VDC	FC/SMA	√	○	○
	WSLS-940-002-M-DC	0 ~ 2W	MM	105um	5VDC	FC/SMA	√	○	○
	WSLS-940-010-M-DC	0 ~ 10W	MM	105um	12VDC	FC/SMA	√	○	○
	WSLS-940-012-M-DC	0 ~ 12W	MM	105um	12VDC	FC/SMA	√	○	○
980nm	WSLS-980-010m-4-DC	0 ~ 10mW	SM	6um	5VDC	FC/SMA	√	○	○
	WSLS-980-020m-4-DC	0 ~ 20mW	SM	6um	5VDC	FC/SMA	√	○	○
	WSLS-980-100m-M-DC	0 ~ 100mW	MM	105um	5VDC	FC/SMA	√	○	○
	WSLS-980-002-M-DC	0 ~ 2W	MM	105um	5VDC	FC/SMA	√	○	○
	WSLS-980-010-M-DC	0 ~ 10W	MM	105um	12VDC	FC/SMA	√	○	○
	WSLS-980-012-M-DC	0 ~ 12W	MM	105um	12VDC	FC/SMA	√	○	○
1064nm	WSLS-1064-010m-4-DC	0 ~ 10mW	SM	6um	5VDC	FC/SMA	√	○	○
	WSLS-1064-030m-4-DC	0 ~ 30mW	SM	6um	5VDC	FC/SMA	√	○	○
	WSLS-1064-050m-4-DC	0 ~ 50mW	SM	6um	5VDC	FC/SMA	√	○	○
	WSLS-1064-010m-PM-DC	0 ~ 10mW	PM	5um	5VDC	FC	√	○	○
	WSLS-1064-030m-PM-DC	0 ~ 30mW	PM	5um	5VDC	FC	√	○	○
	WSLS-1064-050m-PM-DC	0 ~ 50mW	PM	5um	5VDC	FC	√	○	○
	WSLS-1064-001-M-DC	0 ~ 1W	MM	105um	5VDC	FC/SMA	√	○	○
	WSLS-1064-007-M-DC	0 ~ 7W	MM	105um	12VDC	FC/SMA	√	○	○
1210nm	WSLS-1210-001-M-DC	0 ~ 1W	MM	105um	5VDC	FC/SMA	√	○	○
1270nm	WSLS-1270-005m-9-DC	0 ~ 5mW	SM	9um	5VDC	FC/SMA	√	○	○
	WSLS-1270-005m-PM-DC	0 ~ 5mW	PM	9um	5VDC	FC	√	○	○
1280nm	WSLS-1280-001-M-DC	0 ~ 1W	MM	105um	5VDC	FC/SMA	√	○	○
1290nm	WSLS-1290-005m-9-DC	0 ~ 5mW	SM	9um	5VDC	FC/SMA	√	○	○
	WSLS-1290-005m-PM-DC	0 ~ 5mW	PM	9um	5VDC	FC	√	○	○
1310nm	WSLS-1310-005m-9-DC	0 ~ 5mW	SM	9um	5VDC	FC/SMA	√	○	○
	WSLS-1310-010m-9-DC	0 ~ 10mW	SM	9um	5VDC	FC/SMA	√	○	○
	WSLS-1310-015m-9-DC	0 ~ 15mW	SM	9um	5VDC	FC/SMA	√	○	○
	WSLS-1310-005m-PM-DC	0 ~ 5mW	PM	9um	5VDC	FC	√	○	○
	WSLS-1310-010m-PM-DC	0 ~ 10mW	PM	9um	5VDC	FC	√	○	○
	WSLS-1310-015m-PM-DC	0 ~ 15mW	PM	9um	5VDC	FC	√	○	○
	WSLS-1310-001-M-DC	0 ~ 1W	MM	105um	5VDC	FC/SMA	√	○	○
1330nm	WSLS-1330-005m-9-DC	0 ~ 5mW	SM	9um	5VDC	FC/SMA	√	○	○
	WSLS-1330-005m-PM-DC	0 ~ 5mW	PM	9um	5VDC	FC	√	○	○

Note: √:Yes, ○:Optional, ×:No.

Wavelength	Part Number	Output Power Range	Fiber Type	Fiber Core	Supply Voltage	Connector	TEC	Analog	TTL
1330nm	WSLS-1330-001-M-DC	0 ~ 1W	MM	105um	5VDC	FC/SMA	√	○	○
1350nm	WSLS-1350-005m-9-DC	0 ~ 5mW	SM	9um	5VDC	FC/SMA	√	○	○
	WSLS-1350-005m-PM-DC	0 ~ 5mW	PM	9um	5VDC	FC	√	○	○
1370nm	WSLS-1370-005m-9-DC	0 ~ 5mW	SM	9um	5VDC	FC/SMA	√	○	○
	WSLS-1370-005m-PM-DC	0 ~ 5mW	PM	9um	5VDC	FC	√	○	○
1390nm	WSLS-1390-005m-9-DC	0 ~ 5mW	SM	9um	5VDC	FC/SMA	√	○	○
	WSLS-1390-005m-PM-DC	0 ~ 5mW	PM	9um	5VDC	FC	√	○	○
1410nm	WSLS-1410-005m-9-DC	0 ~ 5mW	SM	9um	5VDC	FC/SMA	√	○	○
	WSLS-1410-005m-PM-DC	0 ~ 5mW	PM	9um	5VDC	FC	√	○	○
1430nm	WSLS-1430-005m-9-DC	0 ~ 5mW	SM	9um	5VDC	FC/SMA	√	○	○
	WSLS-1430-005m-PM-DC	0 ~ 5mW	PM	9um	5VDC	FC	√	○	○
1450nm	WSLS-1450-005m-9-DC	0 ~ 5mW	SM	9um	5VDC	FC/SMA	√	○	○
	WSLS-1450-005m-PM-DC	0 ~ 5mW	PM	9um	5VDC	FC	√	○	○
	WSLS-1450-002-M-DC	0 ~ 2W	MM	105um	12VDC	FC/SMA	√	○	○
1470nm	WSLS-1470-005m-9-DC	0 ~ 5mW	SM	9um	5VDC	FC/SMA	√	○	○
	WSLS-1470-005m-PM-DC	0 ~ 5mW	PM	9um	5VDC	FC	√	○	○
	WSLS-1470-001-M-DC	0 ~ 1W	MM	105um	5VDC	FC/SMA	√	○	○
	WSLS-1470-002-M-DC	0 ~ 2W	MM	105um	12VDC	FC/SMA	√	○	○
1490nm	WSLS-1490-005m-9-DC	0 ~ 5mW	SM	9um	5VDC	FC/SMA	√	○	○
	WSLS-1490-005m-PM-DC	0 ~ 5mW	PM	9um	5VDC	FC	√	○	○
	WSLS-1490-002-M-DC	0 ~ 2W	MM	105um	12VDC	FC/SMA	√	○	○
1510nm	WSLS-1510-005m-9-DC	0 ~ 5mW	SM	9um	5VDC	FC/SMA	√	○	○
	WSLS-1510-005m-PM-DC	0 ~ 5mW	PM	9um	5VDC	FC	√	○	○
1530nm	WSLS-1530-005m-9-DC	0 ~ 5mW	SM	9um	5VDC	FC/SMA	√	○	○
	WSLS-1530-005m-PM-DC	0 ~ 5mW	PM	9um	5VDC	FC	√	○	○
	WSLS-1530-002-M-DC	0 ~ 2W	MM	105um	12VDC	FC/SMA	√	○	○
1550nm	WSLS-1550-005m-9-DC	0 ~ 5mW	SM	9um	5VDC	FC/SMA	√	○	○
	WSLS-1550-008m-9-DC	0 ~ 8mW	SM	9um	5VDC	FC/SMA	√	○	○
	WSLS-1550-010m-9-DC	0 ~ 10mW	SM	9um	5VDC	FC/SMA	√	○	○
	WSLS-1550-005m-PM-DC	0 ~ 5mW	PM	9um	5VDC	FC	√	○	○
	WSLS-1550-008m-PM-DC	0 ~ 8mW	PM	9um	5VDC	FC	√	○	○
	WSLS-1550-010m-PM-DC	0 ~ 10mW	PM	9um	5VDC	FC	√	○	○
	WSLS-1550-002-M-DC	0 ~ 2W	MM	105um	12VDC	FC/SMA	√	○	○
1570nm	WSLS-1570-005m-9-DC	0 ~ 5mW	SM	9um	5VDC	FC/SMA	√	○	○
	WSLS-1570-005m-PM-DC	0 ~ 5mW	PM	9um	5VDC	FC	√	○	○
1590nm	WSLS-1590-005m-9-DC	0 ~ 5mW	SM	9um	5VDC	FC/SMA	√	○	○
	WSLS-1590-005m-PM-DC	0 ~ 5mW	PM	9um	5VDC	FC	√	○	○
1610nm	WSLS-1610-005m-9-DC	0 ~ 5mW	SM	9um	5VDC	FC/SMA	√	○	○
	WSLS-1610-005m-PM-DC	0 ~ 5mW	PM	9um	5VDC	FC	√	○	○
1625nm	WSLS-1625-005m-9-DC	0 ~ 5mW	SM	9um	5VDC	FC/SMA	√	○	○

Note: √:Yes, ○:Optional, x:No.

Wavelength	Part Number	Output Power Range	Fiber Type	Fiber Core	Supply Voltage	Connector	TEC	Analog	TTL
1625nm	WLSL-1625-005m-PM-DC	0 ~ 5mW	PM	9um	5VDC	FC	√	○	○
1650nm	WLSL-1650-005m-9-DC	0 ~ 5mW	SM	9um	5VDC	FC/SMA	√	○	○
	WLSL-1650-005m-PM-DC	0 ~ 5mW	PM	9um	5VDC	FC	√	○	○
1720nm	WLSL-1720-001-M-DC	0 ~ 1W	MM	105um	12VDC	FC/SMA	√	○	○
1900nm	WLSL-1900-500m-M-DC	0 ~ 500mW	MM	105um	12VDC	FC/SMA	√	○	○
1920nm	WLSL-1920-500m-M-DC	0 ~ 500mW	MM	105um	12VDC	FC/SMA	√	○	○

Note: √:Yes, ○:Optional, ×:No.

**D100 Package View :**

131mm\*90mm\*33mm

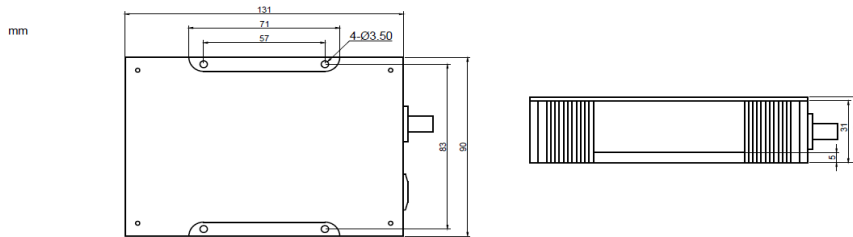

**D200 Package View :**

180mm\*130mm\*35mm

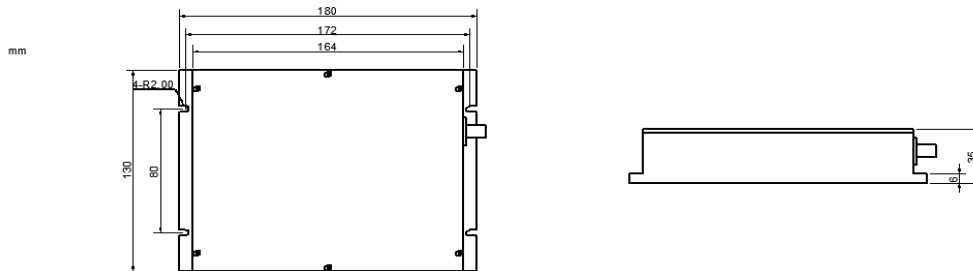

**D300 Package View :**

304mm\*224mm\*207mm

