

905nm~915nm 50mW~60mW SM Coaxial Pigtailed Laser Diode with 9um Fiber | Built-in Photodiode

905nm 50mW SM Fiber Coupled LD with SMF-28 Fiber (9um Fiber Core) | With PD

WSLP-905-050m-9-PD

Wavespectrum Laser Group

www.wavespectrum-laser.com

905nm Pigtailed Diode Laser		50mW/9um		en.wavespectrum-laser.com.cn	
PARAMETER	SYMBOL	VALUE		UNIT	
Reverse Voltage	$V_r$	2.0		V	
Operating Temperature	$T_{op}$	-10~+70		°C	
Storage Temperature	$T_{stg}$	-40~+85		°C	
Lead soldering temperature (10 sec.)	$T_{is}$	260		°C	
<b>Features:</b> <ul style="list-style-type: none"> <li>● 905nm</li> <li>● 9um Fiber</li> <li>● Coaxial or B82 Package</li> <li>● Built-in PD</li> </ul>					
<b>Applications:</b> <ul style="list-style-type: none"> <li>● Medical Laser Treatment</li> <li>● Sensor</li> <li>● Others</li> </ul>					
<b>Specifications</b>	<b>WSLP-905-050m-9-PD</b>				
	Min	Type	Max		
Center Wavelength@25°C	±5nm	905nm	±10nm		
Recommended Operating Temperature	25°C				
Output Power	----	50mW	----		
Fiber Type	SMF-28				
Fiber Core	9um				
Monitor Current	----	0.3mA	----		
PD Reverse Voltage	----	----	30V		
Fiber Connector	FC/SC/SMA905				
Fiber Length	----	80cm	100cm		
Threshold Current (Typ.)	----	30mA	65mA		
Operating Current (Typ.)	----	220mA	240mA		
Operating Voltage	----	2.2V	2.8V		
Package Style	Coaxial or B82				
Photodiodes	Built-in				

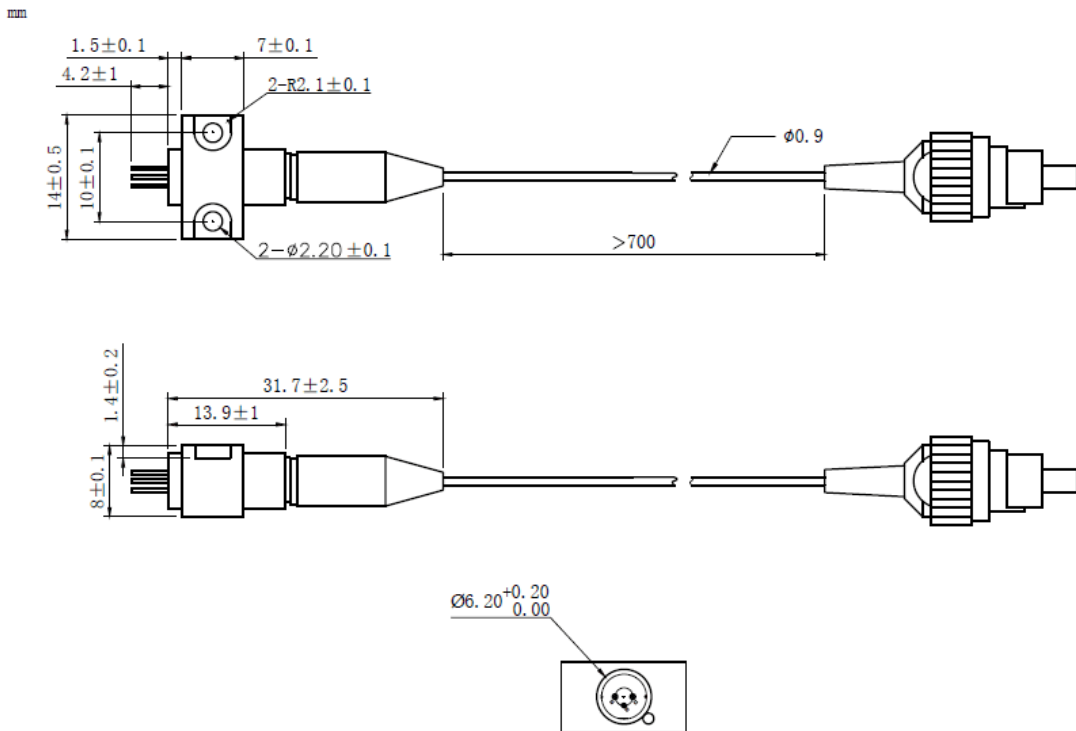
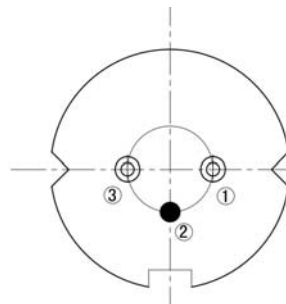

**Coaxial Package View: (Part Number: WSLP-905-050m-9-PD)**

**B82 Package View: (Part Number: WSLP-905-050m-9-B-PD)**

**PIN Bottom View:**

1	LD(-)
2	LD(+) & PD(-)
3	PD(+)



Electrically shorten LD module and store in non-extreme conditions.  
Suggest using the constant current power supply.

