

905nm 1mW~2mW SM Coaxial Pigtailed Laser Diode with SMF | Built-in Photodiode

905nm~915nm 2mW SM Fiber Coupled LD with Single Mode Fiber (SM Fiber) | With PD

WSLP-905-002m-4-PD

Wavespectrum Laser Group

www.wavespectrum-laser.com

905nm Pigtailed Diode Laser		2mW/SM Fiber		Wavespectrum Laser Group	
PARAMETER	SYMBOL	VALUE		UNIT	
Reverse Voltage	V_r	2.0		V	
Operating Temperature	T_{op}	-10~+60		°C	
Storage Temperature	T_{stg}	-40~+85		°C	
Lead soldering temperature (10 sec.)	T_{is}	260		°C	
Features: <ul style="list-style-type: none"> ● 905nm ● SM Fiber ● Coaxial or B82 Package ● Built-in PD 					
Applications: <ul style="list-style-type: none"> ● Medical Laser Treatment ● Sensor ● Others 					
Specifications	WSLP-905-002m-4-PD				
	Min	Type	Max		
Center Wavelength@25°C	±10nm	905nm	±20nm		
Recommended Operating Temperature	25°C				
Output Power	1mW	2mW	---		
Fiber Type	Single Mode Fiber				
Fiber Core	5um				
Monitor Current	---	0.2mA	---		
PD Reverse Voltage	---	---	30V		
Fiber Connector	FC/SC/SMA905				
Fiber Length	---	80cm	100cm		
Threshold Current (Typ.)	---	10mA	25mA		
Operating Current (Typ.)	---	35mA	50mA		
Operating Voltage	---	1.8V	2.4V		
Package Style	Coaxial or B82				
Photodiodes	Built-in				

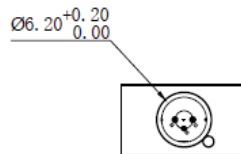
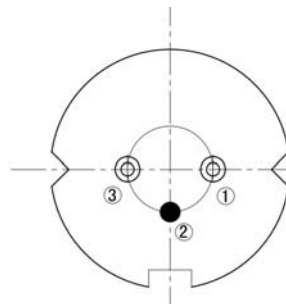

Coaxial Package View: (Part Number: WSLP-905-002m-4-PD)

B82 Package View: (Part Number: WSLP-905-002m-4-B-PD)

PIN Bottom View:

1	LD(-)
2	LD(+)&PD(-)
3	PD(+)



Electrically shorten LD module and store in non-extreme conditions.
Suggest using the constant current power supply.

