

**850nm 10mW~15mW SM Coaxial Pigtailed Laser Diode with SMF | Infrared Diode Laser Module**
**850nm 10mW Fiber Coupled LD with Single Mode Fiber (SM Fiber) | Built-in Photodiode (PD)**
**WSLP-850-010m-4-PD**
**Wavespectrum Laser Group**
**www.wavespectrum-laser.com**

850nm Pigtailed Diode Laser		10mW/SM Fiber		en.wavespectrum-laser.com.cn	
PARAMETER	SYMBOL	VALUE		UNIT	
Reverse Voltage	$V_r$	2.0		V	
Operating Temperature	$T_{op}$	-10~+50		°C	
Storage Temperature	$T_{stg}$	-40~+80		°C	
Lead soldering temperature (10 sec.)	$T_{is}$	260		°C	
<b>Features:</b> <ul style="list-style-type: none"> <li>● 850nm</li> <li>● With SM Fiber</li> <li>● Coaxial or B82 Package</li> <li>● Built-in PD</li> </ul>					
<b>Applications:</b> <ul style="list-style-type: none"> <li>● Medical Laser Treatment</li> <li>● Sensor</li> <li>● Others</li> </ul>					
<b>Specifications</b>	<b>WSLP-850-010m-4-PD</b>				
	Min	Type	Max		
Center Wavelength@25°C	840nm	850nm	860nm		
Recommended Operating Temperature	25°C				
Output Power	----	10mW	----		
Fiber Type	Single Mode Fiber				
Fiber Core	5um				
Monitor Current	----	0.2mA	----		
PD Reverse Voltage	----	----	30V		
Fiber Connector	FC/SC/SMA905				
Fiber Length	----	80cm	100cm		
Threshold Current (Typ.)	----	15mA	30mA		
Operating Current (Typ.)	----	80mA	90mA		
Operating Voltage	----	2.3V	2.8V		
Package Style	Coaxial or B82				
Photodiodes	Built-in				

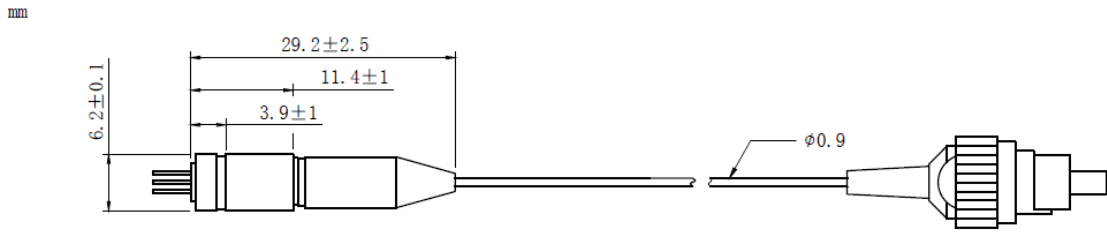
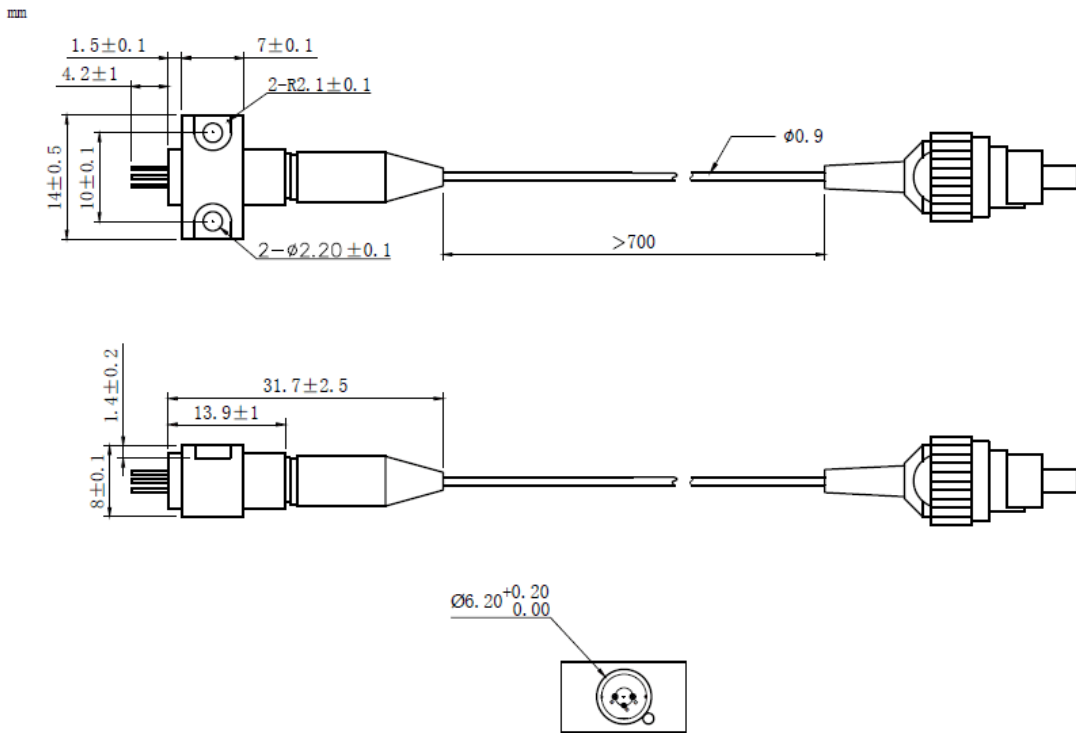
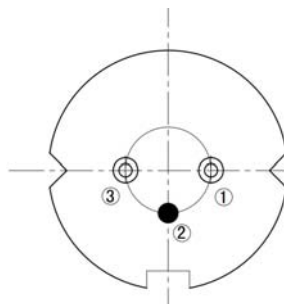

**Coaxial Package View: (Part Number: WSLP-850-010m-4-PD)**

**B82 Package View: (Part Number: WSLP-850-010m-4-B-PD)**

**PIN Bottom View:**

1	LD(-)
2	LD(+)&PD(-)
3	PD(+)



Electrically shorten LD module and store in non-extreme conditions.  
Suggest using the constant current power supply.

