

785nm 30mW~40mW SM Coaxial Pigtailed Laser Diode Module with 9um Fiber| Built-in PD

780nm~785nm 30mW SM Fiber Coupled LD with SMF-28 Fiber

WSLP-785-030m-9-PD

Wavespectrum Laser Group

www.wavespectrum-laser.com

785nm Pigtailed Diode Laser		30mW/9um		en.wavespectrum-laser.com.cn
PARAMETER	SYMBOL	VALUE	UNIT	
Reverse Voltage	V_r	2.0	V	
Operating Temperature	T_{op}	-10~+60	°C	
Storage Temperature	T_{stg}	-40~+85	°C	
Lead soldering temperature (10 sec.)	T_{is}	260	°C	
Features: <ul style="list-style-type: none"> ● 785nm ● 9um Fiber ● Coaxial or B82 Package ● Built-in PD 				
Applications: <ul style="list-style-type: none"> ● Medical Laser Treatment ● Others 				
Specifications	WSLP-785-030m-9-PD			
	Min	Type	Max	
Center Wavelength@25°C	±5nm	785nm	±10nm	
Recommended Operating Temperature	25°C			
Output Power	----	30mW	----	
Fiber Type	SMF-28			
Fiber Core	9um			
Monitor Current	----	0.3mA	----	
PD Reverse Voltage	----	----	30V	
Fiber Connector	FC/SC/SMA905			
Fiber Length	----	80cm	100cm	
Threshold Current (Typ.)	----	30mA	55mA	
Operating Current (Typ.)	----	100mA	120mA	
Operating Voltage	----	2.2V	2.5V	
Package Style	Coaxial or B82			
PD	Built-in			

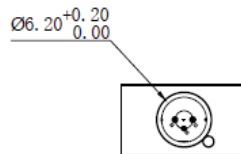
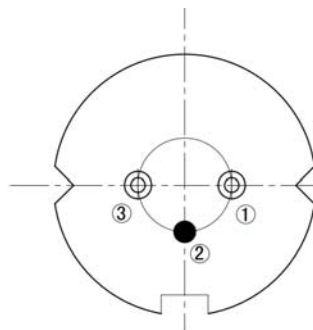

Coaxial Package View: (Part Number: WSLP-785-030m-9-PD)

B82 Package View: (Part Number: WSLP-785-030m-9-B-PD)

PIN Bottom View:

1	LD(-)
2	LD(+)&PD(-)
3	PD(+)



Electrically shorten LD module and store in non-extreme conditions.
Suggest using the constant current power supply.

