

**785nm 10mW SM Coaxial Pigtailed Laser Diode Module with 9um Fiber| Built-in PD | Heat-sink Optional**
**780nm~785nm 10mW SM Fiber Coupled LD with SMF-28 Fiber**
**WSLP-785-010m-9-PD**
**Wavespectrum Laser Group**
**www.wavespectrum-laser.com**
**en.wavespectrum-laser.com.cn**

785nm Pigtailed Diode Laser		10mW/9um	
PARAMETER	SYMBOL	VALUE	UNIT
Reverse Voltage	$V_r$	2.0	V
Operating Temperature	$T_{op}$	-10~+60	°C
Storage Temperature	$T_{stg}$	-40~+85	°C
Lead soldering temperature (10 sec.)	$T_{is}$	260	°C
<b>Features:</b> <ul style="list-style-type: none"> <li>● 785nm</li> <li>● 9um Fiber</li> <li>● Coaxial or B82 Package</li> <li>● Built-in PD</li> </ul>			
<b>Applications:</b> <ul style="list-style-type: none"> <li>● Medical Laser Treatment</li> <li>● Others</li> </ul>			
<b>Specifications</b>	<b>WSLP-785-010m-9-PD</b>		
	Min	Type	Max
Center Wavelength@25°C	±5nm	785nm	±15nm
Recommended Operating Temperature	25°C		
Output Power	----	10mW	----
Fiber Type	SMF-28		
Fiber Core	9um		
Monitor Current	----	0.5mA	----
PD Reverse Voltage	----	----	30V
Fiber Connector	FC/SC/SMA905		
Fiber Length	----	80cm	100cm
Threshold Current (Typ.)	----	10mA	30mA
Operating Current (Typ.)	----	40mA	60mA
Operating Voltage	----	1.9V	2.4V
Package Style	Coaxial or B82		
PD	Built-in		

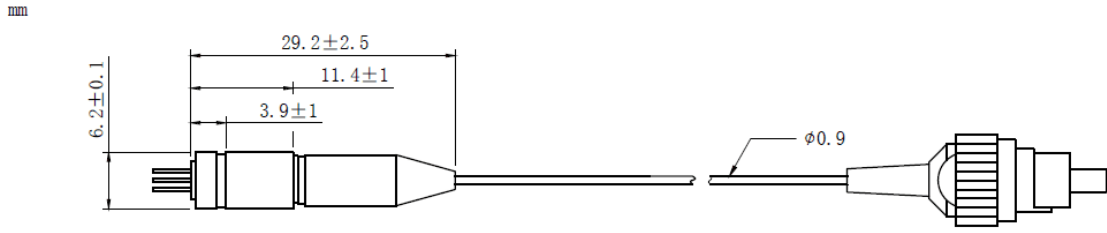
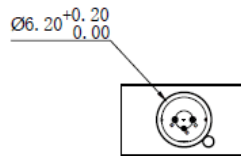
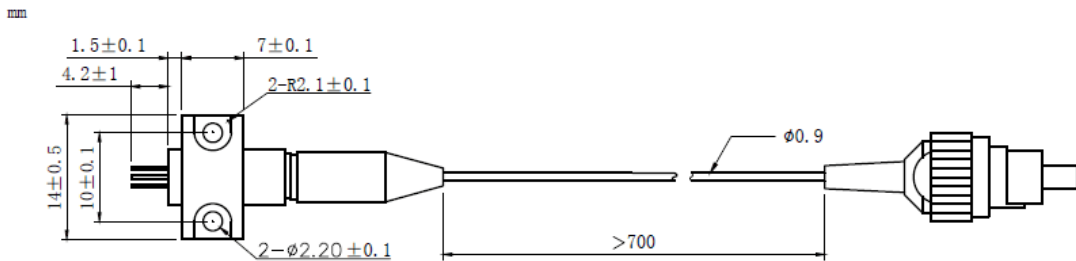
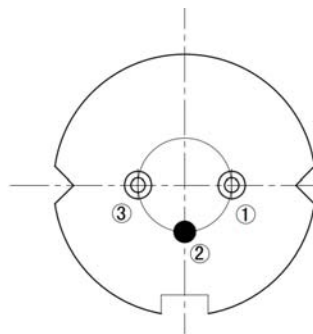

**Coaxial Package View: (Part Number: WSLP-785-010m-9-PD)**

**B82 Package View: (Part Number: WSLP-785-010m-9-B-PD)**

**PIN Bottom View:**

1	LD(-)
2	LD(+)&PD(-)
3	PD(+)



Electrically shorten LD module and store in non-extreme conditions.  
Suggest using the constant current power supply.

