

520nm 25mW Coaxial Diode Laser with Polarization Maintaining Fiber| Built-in Photodiode
515nm~520nm~530nm 25mW PM Fiber Coupled Green LD with SMF | With PD

WSLP-520-025m-PM-PD

Wavespectrum Laser Group

www.wavespectrum-laser.com
en.wavespectrum-laser.com.cn

520nm Pigtailed Diode Laser		25mW/PMF	
PARAMETER	SYMBOL	VALUE	UNIT
Reverse Voltage	V_r	2.0	V
Operating Temperature	T_{op}	-20 ~ +60	°C
Storage Temperature	T_{stg}	-40 ~ +85	°C
Lead soldering temperature (10 sec.)	T_{is}	260	°C
Features: <ul style="list-style-type: none"> 520nm Green Diode Laser PM Fiber High Reliability High Polarization Extinction Ratio 			
Applications: <ul style="list-style-type: none"> Biological Instruments Analytical Equipment Others 			
Specifications	WSLP-520-025m-PM-PD		
	Min	Type	Max
Center Wavelength@25°C	510nm	520nm	530nm
Spectral Width (FWHM)	----	2.0nm	----
Output Power	----	25mW	----
Fiber Type	Polarization Maintaining Fiber		
Fiber Core	3um		
Polarization Extinction Ratio	13dB	15dB	----
Recommend Operating Temperature	25°C		
Fiber Connector	FC/APC		
Fiber Length	----	80cm	100cm
Threshold Current	----	45mA	85mA
Operating Current	----	210mA	230mA
Operating Voltage	----	7.5V	8.0V
Photodiode	Built-in		
Package Style	Coaxial or B82		
High Polarization Extinction Ratio (PER) Version Laser Module is also available, please contact us.			

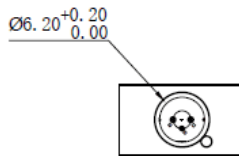
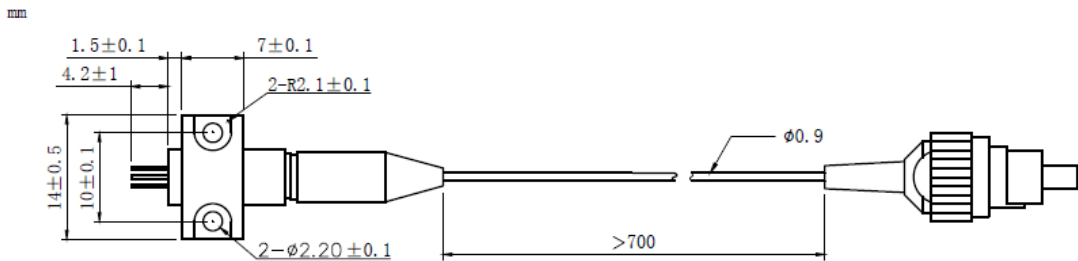
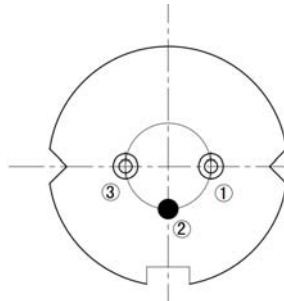

Coaxial Package View: (Part Number: WSLP-520-025m-PM-PD)

B82 Package View: (Part Number: WSLP-520-025m-PM-B-PD)

PIN Bottom View:

1	LD(-)
2	LD(+)&PD(-)
3	PD(+)



Electrically shorten LD module and store in non-extreme conditions.
Suggest using the constant current power supply.

