

515nm~520nm 1mW~2mW SM Coaxial Fiber Coupled Laser Diode with SMF|Built-in Photodiode
510nm~520nm~530nm SM Pigtailed Green LD with Single Mode Fiber (SM Fiber) | With PD
WSLP-520-001m-4-PD Wavespectrum Laser Group www.wavespectrum-laser.com

520nm Pigtailed Diode Laser	1mW/SMF	en.wavespectrum-laser.com.cn
------------------------------------	----------------	--

PARAMETER	SYMBOL	VALUE	UNIT
Reverse Voltage	V_r	2.0	V
Operating Temperature	T_{op}	-20~+60	°C
Storage Temperature	T_{stg}	-40~+85	°C
Lead soldering temperature (10 sec.)	T_{is}	260	°C

Features: <ul style="list-style-type: none"> 520nm Green Diode Laser 3um SM Fiber Coaxial or B82 Package Built-in Photodiode 	
Applications: <ul style="list-style-type: none"> Medical Laser Treatment Others 	

Specifications	WSLP-520-001m-4-PD		
	Min	Type	Max
Center Wavelength@25°C	+/-5nm	520nm	+/-10nm
Spectral Width (FWHM)	----	2.0nm	----
Output Power	----	1mW	----
Fiber Type	Single Mode Fiber		
Fiber Core	3um		
PD Current	100uA		
Recommend Operating Temperature	25°C		
Fiber Connector	FC/SC/SMA905		
Fiber Length	----	80cm	100cm
Threshold Current	----	30mA	55mA
Operating Current	----	60mA	80mA
Operating Voltage	----	5.8V	7.0V
Package Style	Coaxial or B82		
Photodiode	Built-in		

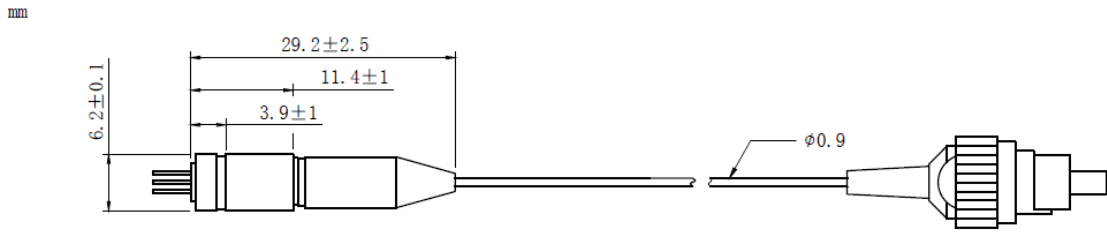
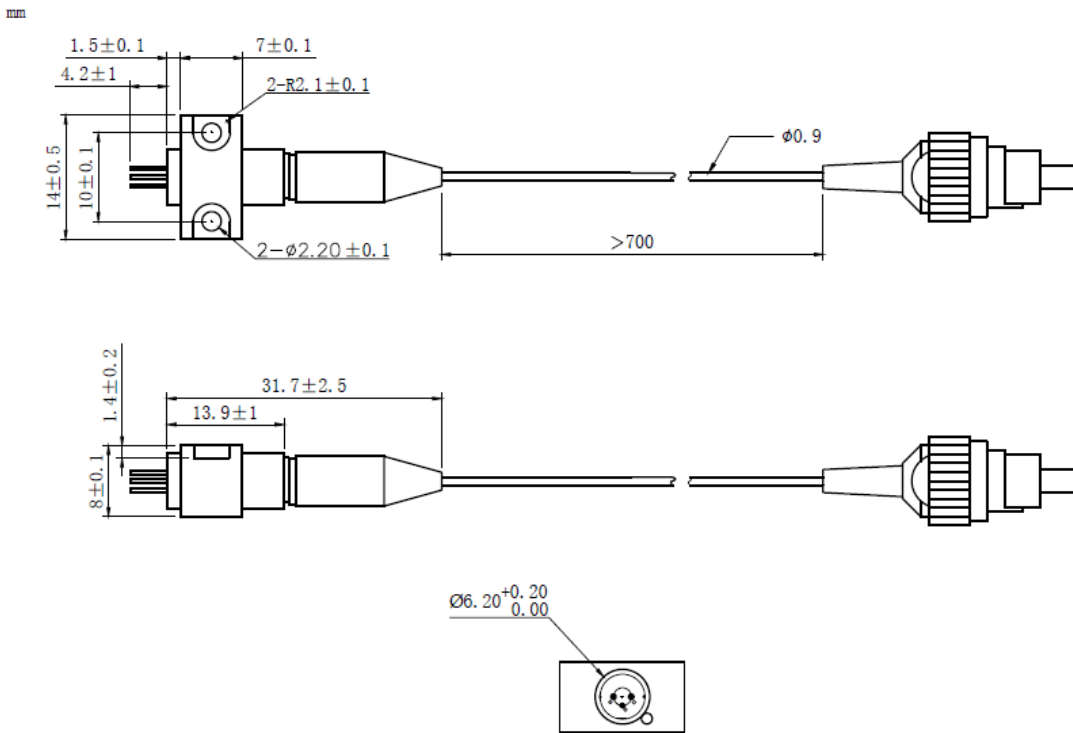
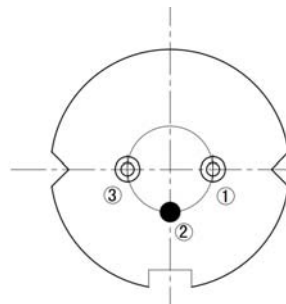

Coaxial Package View: (Part Number: WSLP-520-001m-4-PD)

B82 Package View: (Part Number: WSLP-520-001m-4-B-PD)

PIN Bottom View:

1	LD(-)
2	LD(+)&PD(-)
3	PD(+)



Electrically shorten LD module and store in non-extreme conditions.
Suggest using the constant current power supply.

