

**520nm 25mW~30mW SM Coaxial Fiber Coupled Laser Diode with SMF| Built-in Photodiode**  
**515nm~520nm~530nm SM Pigtailed Green LD with Single Mode Fiber (SM Fiber) | With PD**  
**WSLP-520-030m-4-PD**      Wavespectrum Laser Group      [www.wavespectrum-laser.com](http://www.wavespectrum-laser.com)

520nm Pigtailed Diode Laser 30mW/SMF		Wavespectrum Laser Group	
PARAMETER	SYMBOL	VALUE	UNIT
Reverse Voltage	$V_r$	2.0	V
Operating Temperature	$T_{op}$	-10~+60	°C
Storage Temperature	$T_{stg}$	-40~+85	°C
Lead soldering temperature (10 sec.)	$T_{is}$	260	°C
<b>Features:</b> <ul style="list-style-type: none"> <li>🔸 520nm Green Diode Laser</li> <li>🔸 3um SM Fiber</li> <li>🔸 Coaxial or B8 Package</li> <li>🔸 Built-in Photodiode</li> </ul>			
<b>Applications:</b> <ul style="list-style-type: none"> <li>🔸 Medical Laser Treatment</li> <li>🔸 Others</li> </ul>			
<b>Specifications</b>	<b>WSLP-520-030m-4-PD</b>		
	Min	Type	Max
Center Wavelength@25°C	+/-5nm	520nm	+/-10nm
Spectral Width (FWHM)	----	2.0nm	----
Output Power	----	25mW	30mW
Fiber Type	Single Mode Fiber		
Fiber Core	3um		
PD Current	100uA		
Recommend Operating Temperature	25°C		
Fiber Connector	FC/SC/SMA905		
Fiber Length	----	80cm	100cm
Threshold Current (Typ.)	----	45mA	80mA
Operating Current (Typ.)	----	160mA	180mA
Operating Voltage	----	7.5V	8.0V
Package Style	Coaxial or B8		
Photodiode	Built-in		

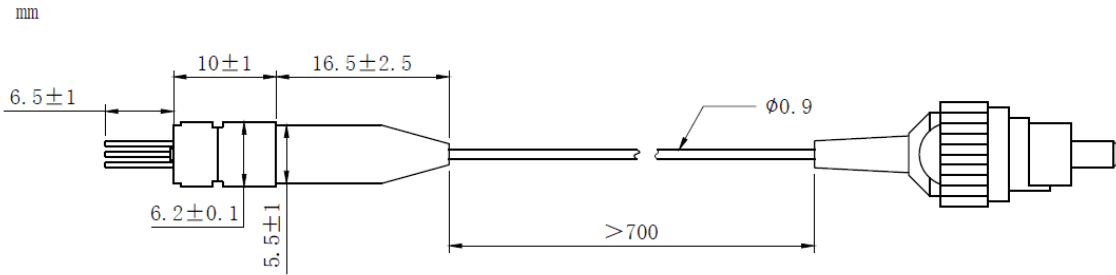

### Coaxial Package View



### B8 Package View

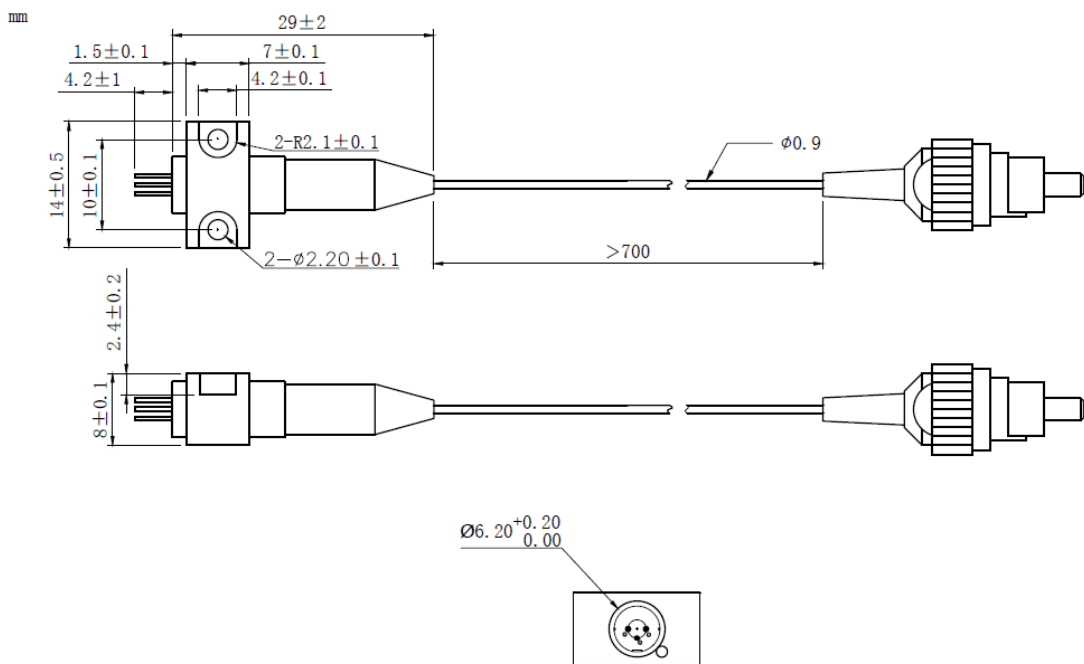

### PIN Bottom View:

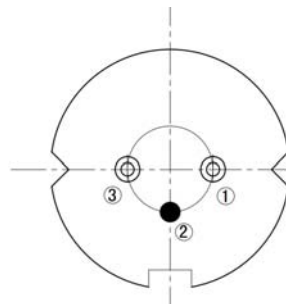

<b>1</b>	<b>LD(-)</b>
<b>2</b>	<b>LD(+)&amp;PD(-)</b>
<b>3</b>	<b>PD(+)</b>



Electrically shorten LD module and store in non-extreme conditions.  
Suggest using the constant current power supply.

