

705nm 20mW~30mW Pigtailed Laser diode with SMF | Single Mode Laser Diode Module | With PD

700nm~705nm~710nm SM Fiber Coupled LD With Single Mode Fiber (SM Fiber) | Built-in Photodiode

WSLP-705-030m-4-PD

Wavespectrum Laser Group

www.wavespectrum-laser.com

705nm Pigtailed Diode Laser		30mW/SM Fiber		Wavespectrum Laser Group	
PARAMETER	SYMBOL	VALUE	UNIT		
Reverse Voltage	V_r	2.0		V	
Operating Temperature	T_{op}	-10~+60		°C	
Storage Temperature	T_{stg}	-40~+85		°C	
Lead soldering temperature (10 sec.)	T_{is}	260		°C	
Features: <ul style="list-style-type: none"> ● 705nm ● With SM Fiber ● Coaxial Package ● Built-in PD 					
Applications: <ul style="list-style-type: none"> ● Medical Laser Treatment ● Others 					
Specifications	WSLP-705-030m-4-PD				
	Min	Type	Max		
Center Wavelength@25°C	$\pm 3\text{nm}$	705nm	$\pm 10\text{nm}$		
Recommend Operating Temperature	25°C				
Output Power	20mW	30mW	----		
Fiber Type	Single Mode Fiber				
Fiber Core	4 μm				
Monitor Current	----	0.5mA	----		
PD Reverse Voltage	----	30V	----		
Fiber Connector	FC/SC/SMA905				
Fiber Length	----	80cm	100cm		
Threshold Current (Typ.)	----	35mA	60mA		
Operating Current (Typ.)	----	80mA	100mA		
Operating Voltage	----	2.5V	3.0V		
Package Style	Coaxial				
PD	Built-in				



Coaxial Package View

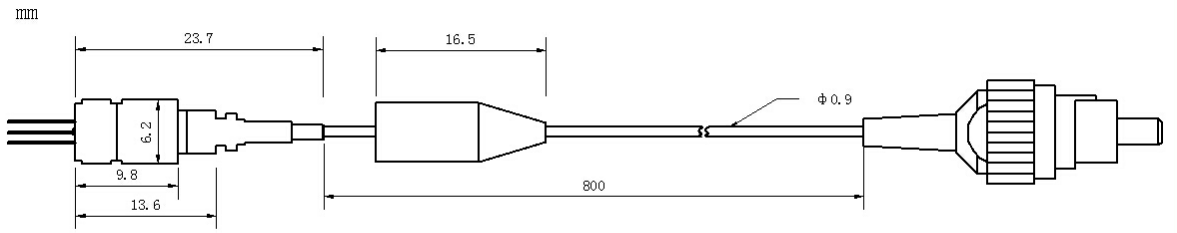

PIN Bottom View:

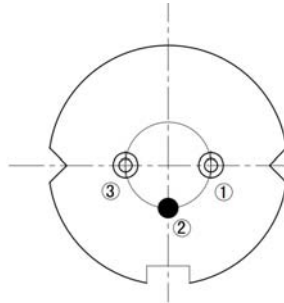

1	LD(-)
2	LD(+) & PD(-)
3	PD(+)

Electrically shorten LD module and store in non-extreme conditions.
 Suggest using the constant current power supply.

