

1060nm~1064nm 5mW~10mW SM Coaxial Pigtailed Laser Diode with Single Mode Fiber
1064nm | 5mW~10mW | SM Fiber Coupled LD | Built-in PD | SMF LD Module
WSLP-1064-005m-4-PD
Wavespectrum Laser Group
www.wavespectrum-laser.com

| 1064nm Pigtailed Diode Laser | | 5mW/SMF | | Wavespectrum Laser Group | |
|--|--|-----------|------------|--------------------------|--|
| PARAMETER | SYMBOL | VALUE | UNIT | | |
| Reverse Voltage | V_r | 2.0 | V | | |
| Operating Temperature | T_{op} | -10~+50 | °C | | |
| Storage Temperature | T_{stg} | -40 ~ +85 | °C | | |
| Lead soldering temperature (5 sec.) | T_{is} | 250 | °C | | |
| Features: <ul style="list-style-type: none"> ● 1064nm ● 6um Single Mode Fiber ● Coaxial package ● Built-in PD |  | | | | |
| Applications: <ul style="list-style-type: none"> ● Medical laser treatment ● Sensor ● Others | | | | | |
| Specifications | WSLP-1064-005m-4-PD | | | | |
| | Min | Type | Max | | |
| Center Wavelength@25°C | $\pm 3nm$ | 1064nm | $\pm 10nm$ | | |
| Recommend Operating Temperature | 25°C | | | | |
| Output Power | ---- | 5mw | ---- | | |
| Fiber Type | SM Fiber | | | | |
| Fiber Core | 6um | | | | |
| Monitor Current | ---- | 0.3mA | ---- | | |
| PD Reverse Voltage | ---- | 30V | ---- | | |
| Fiber Connector | FC/SC/SMA905 | | | | |
| Fiber Length | ---- | 80cm | 100cm | | |
| Threshold Current (Typ.) | ---- | 25mA | 40mA | | |
| Operating Current (Typ.) | ---- | 100mA | 120mA | | |
| Operating Voltage | ---- | 1.5V | 2.0V | | |
| Package Style | Coaxial | | | | |
| Photodiodes | Built-in | | | | |

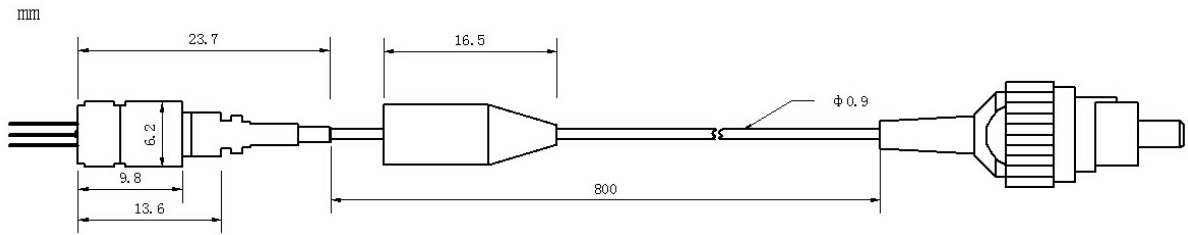

Coaxial Package View



PIN Bottom View:

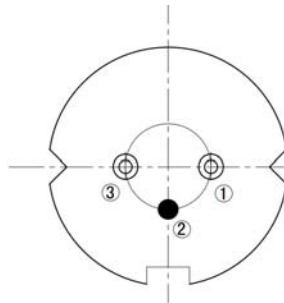

| | |
|---|-------------|
| 1 | LD(-) |
| 2 | LD(+)&PD(-) |
| 3 | PD(+) |

Electrically shorten LD module and store in non-extreme conditions.
 Suggest using the constant current power supply.



Wavespectrum Laser Group
www.wavespectrum-laser.com
sales@wavespectrum-laser.com

