

**980nm 5mw SM Coaxial Pigtailed Laser Diode with 6um SMF | Built-in PD**
**976nm~980nm SM Fiber Coupled LD with Single Mode Fiber (SM Fiber) | With Photodiode**
**WSLP-980-005m-4-PD**
**Wavespectrum Laser Group**
**www.wavespectrum-laser.com**

980nm Pigtailed Diode Laser		5mW/SM Fiber		Wavespectrum Laser Group	
PARAMETER	SYMBOL	VALUE	UNIT		
Reverse Voltage	$V_r$	2.0	V		
Operating Temperature	$T_{op}$	-10~+40	°C		
Storage Temperature	$T_{stg}$	-15~+85	°C		
Lead soldering temperature (5 sec.)	$T_{is}$	250	°C		
<b>Features:</b> <ul style="list-style-type: none"> <li>● 980nm</li> <li>● 6um SM Fiber</li> <li>● Coaxial Package</li> <li>● Built-in PD</li> </ul>					
<b>Applications:</b> <ul style="list-style-type: none"> <li>● Medical laser treatment</li> <li>● Others</li> </ul>					
<b>Specifications</b>	<b>WSLP-980-005m-4-PD</b>				
	Min	Type	Max		
Center Wavelength@25°C	±3nm	980nm	±10nm		
Recommend Operating Temperature	25°C				
Output Power	----	5mw	----		
Fiber Type	Single Mode Fiber				
Fiber Core	6um				
Monitor Current	----	0.5mA	----		
PD Reverse Voltage	----	30V	----		
Fiber Connector	FC				
Fiber Length	----	80cm	100cm		
Threshold Current (Typ.)	----	15mA	25mA		
Operating Current (Typ.)	----	75mA	90mA		
Operating Voltage	----	1.6V	2.2V		
Package Style	Coaxial				
Photodiodes	Built-in				

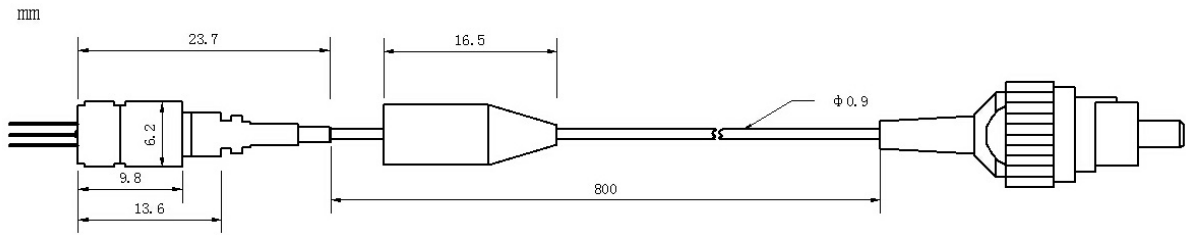

### Coaxial Package View



### PIN Bottom View:

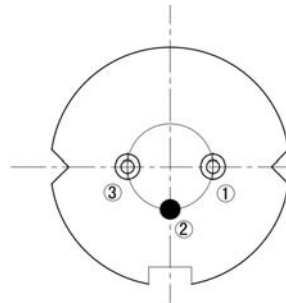

1	LD(-)
2	LD(+)&PD(-)
3	PD(+)

Electrically shorten LD module and store in non-extreme conditions.  
 Suggest using the constant current power supply.

